

Installation Guidelines

NOVADISPLAY®
INNOVATIVE DISPLAY SOLUTIONS

Generic Sign & Panel Support

800.753.9688 www.novadisplay.com

Sign & Panel Support Installation

- 1) Use the panel as a template to determine where on the installation surface to drill the necessary holes.

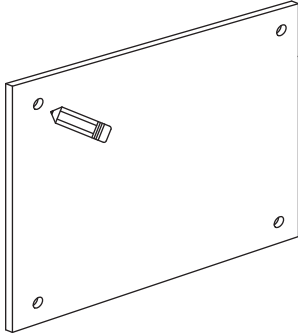

- 2) Secure Support to mounting surface. See installation tips below. (ensuring that fixings are secure).
- 3) Place panels on Support and secure with the Screw Caps.

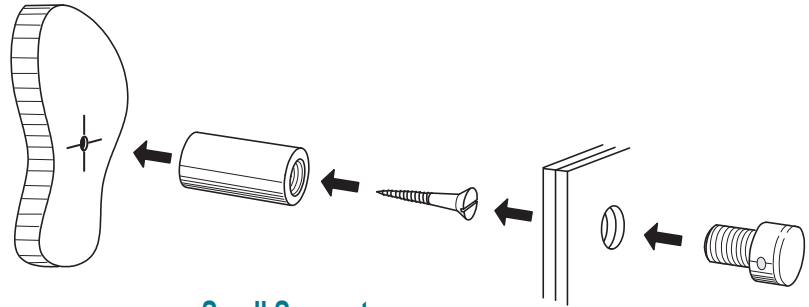

Small Support

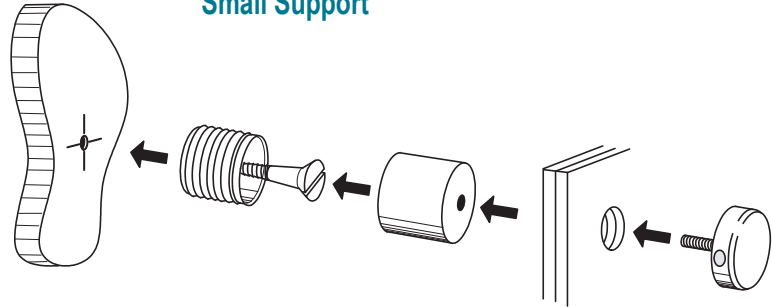

Medium Short & Long Supports

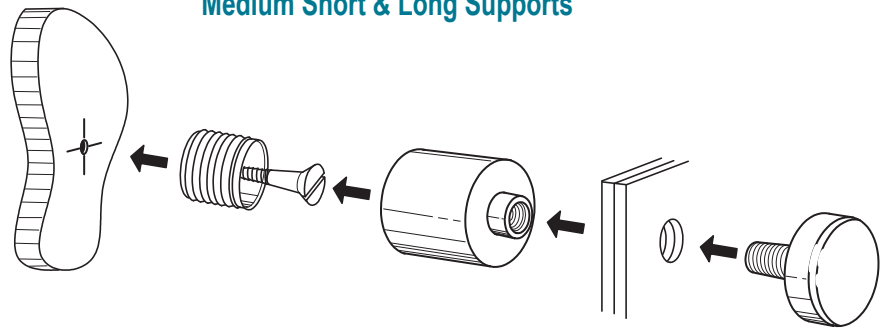

Large Supports

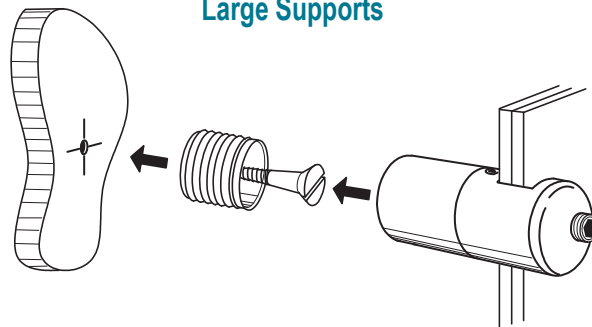

Edge Grip Support

INSTALLATION TIPS

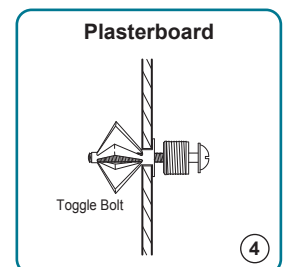
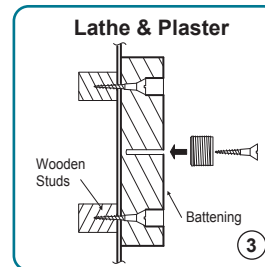
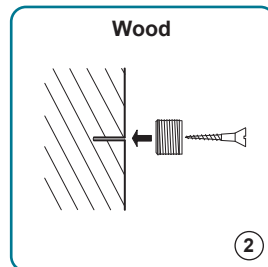
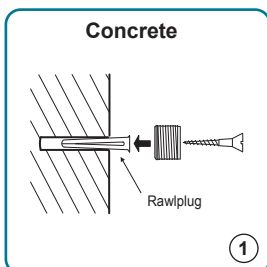

Installation Guidelines

NOVADISPLAY
INNOVATIVE DISPLAY SOLUTIONS

Generic Sign & Panel Support

800.753.9688 www.novadisplay.com

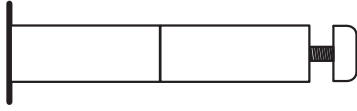

Customize Length...

Join medium short and long supports to create a longer wall bracket...

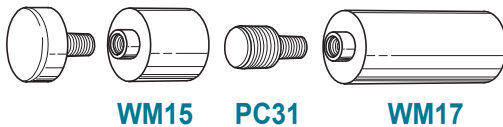
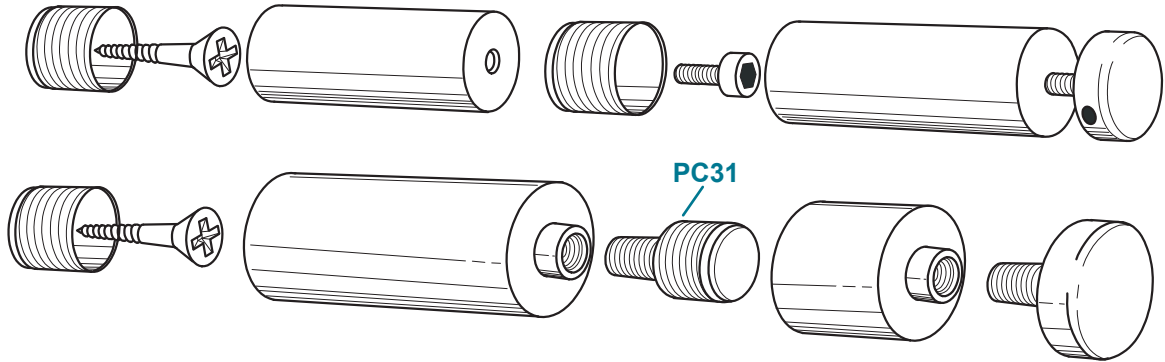

Double Depth Panels...

Make a strong design statement by using one panel in front of another, thus creating a double depth sign. This look can be achieved by joining two supports with the PC31. These supports can accommodate up to 6mm thick.

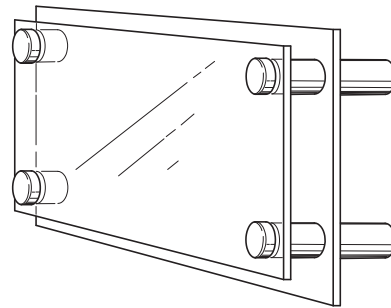
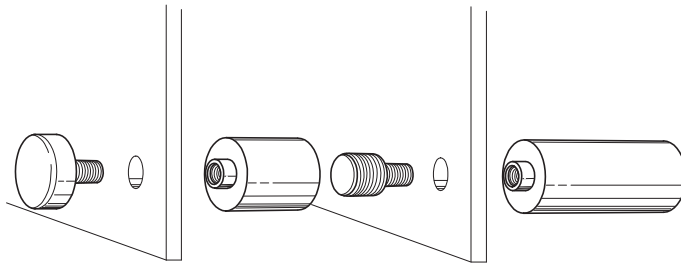

INSTALLATION TIPS

