

Free-Style Display Installation Guidelines

NOVADISPLAY®
INNOVATIVE DISPLAY SOLUTIONS

KFTR-001 • KFTR-006, KFTR-009 • KFTR-010, KFTR-013 • KFTR-027

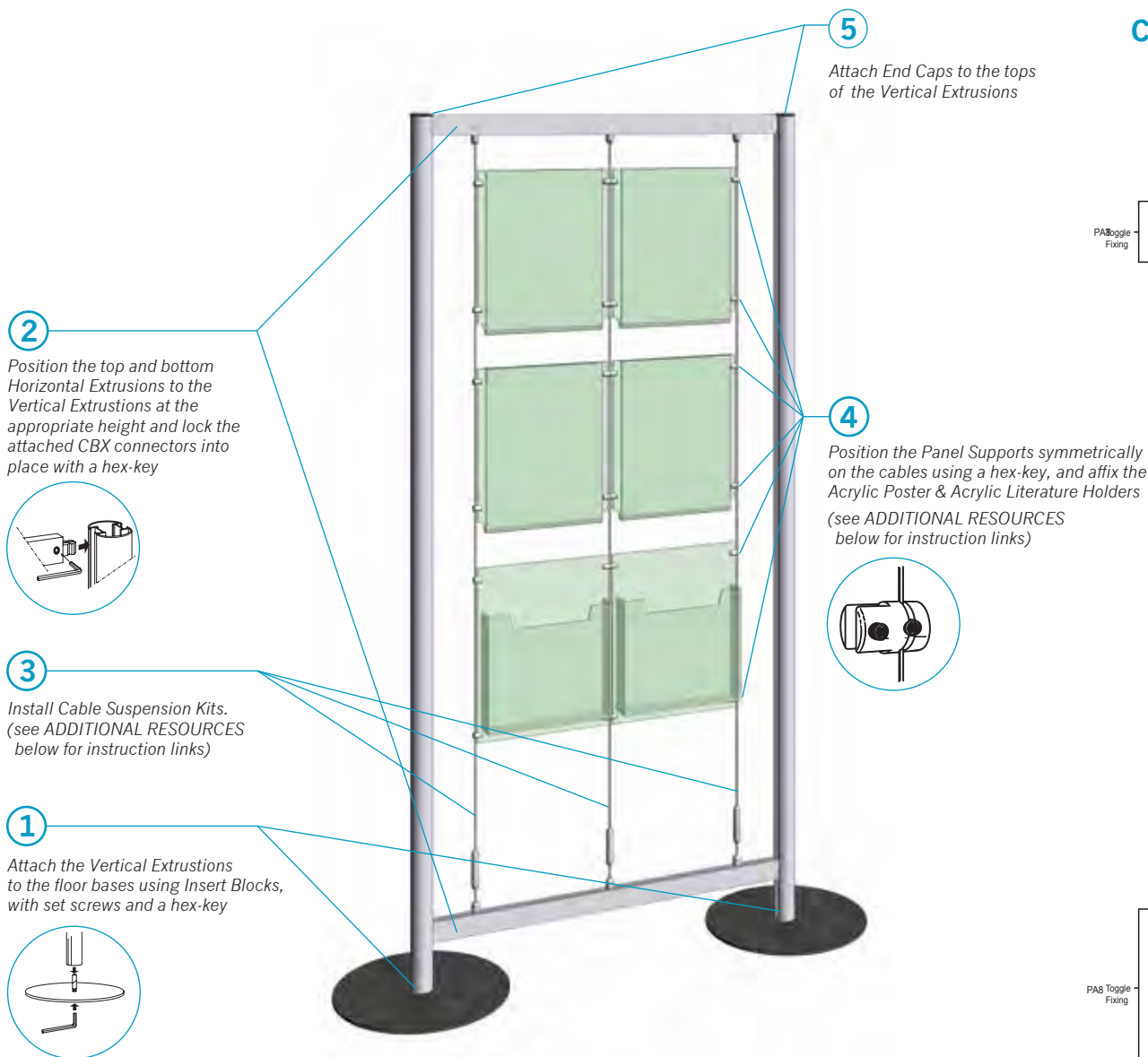

CABLE OPTIONS

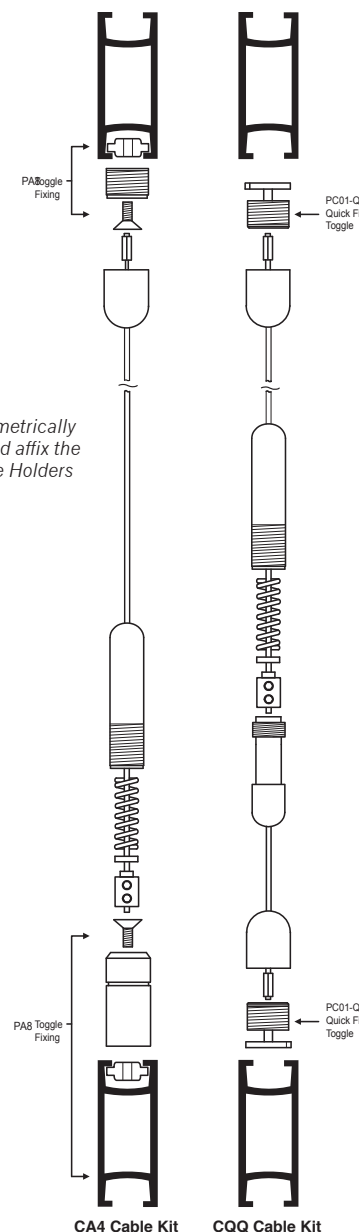

Each Kit includes the Cable Kit shown in the illustration. For alternate cabling options contact Customer Service.

Read instruction sheet carefully before starting assembly □ Separate all parts and check quantities □ Account for all parts before discarding any packaging materials

ADDITIONAL RESOURCE LINKS:

Reference **CA4 Cable Kit** & **CQQ Cable Kit** Installation Guides for cable assembly

Reference **CG01** & **CG03 Panel Support** Installation Guides for panel support assembly

INDEX OF APPLICABLE MODELS:

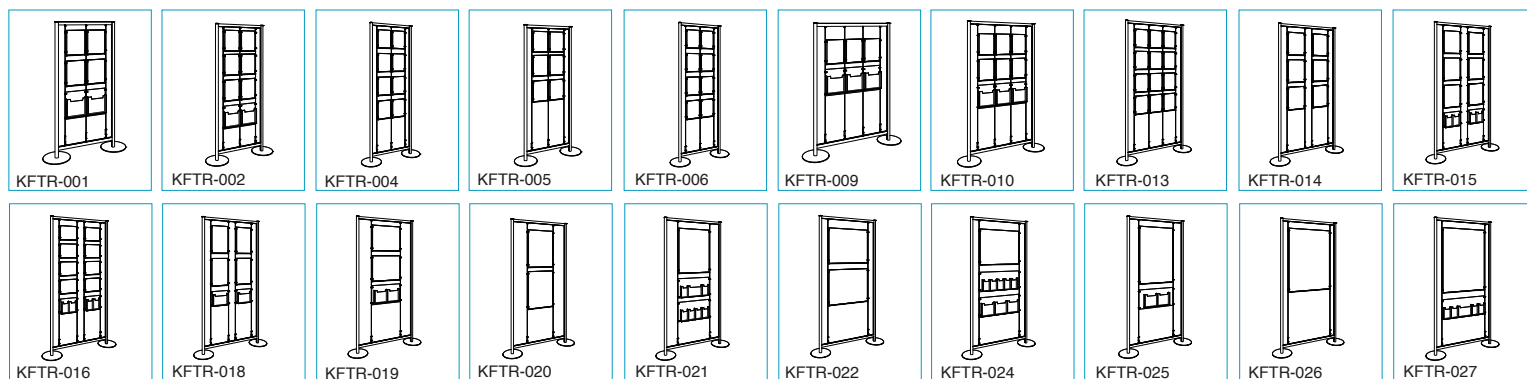

Toll: 800-753-9688 | Phone: 707-535-0253 | Fax: 707-535-0254 | E-mail: info@novadisplay.com | Web: www.novadisplay.com

Free-Style Display Installation Guidelines

KFTR-003, KFTR-007, KFTR-008, KFTR-011, KFTR-012, KFTR-023

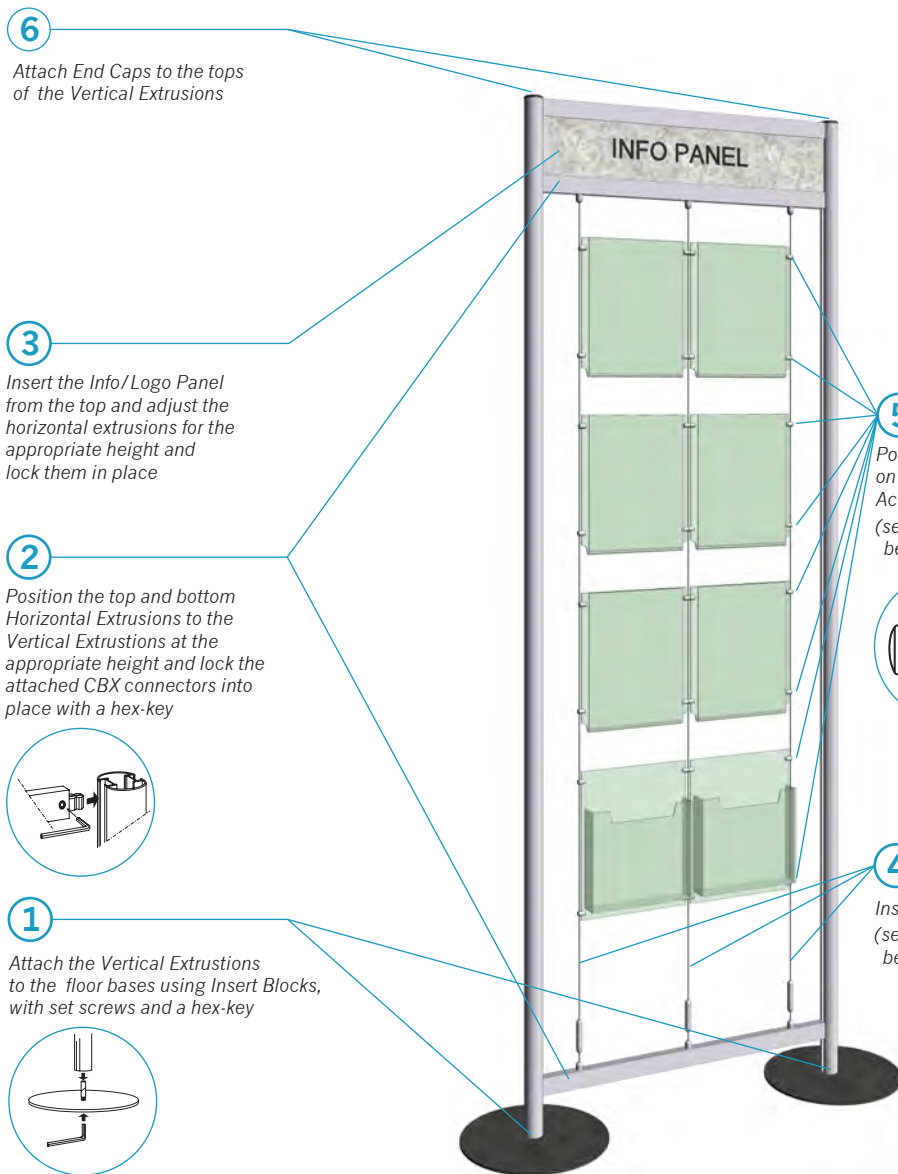

6
Attach End Caps to the tops of the Vertical Extrusions

3
Insert the Info/Logo Panel from the top and adjust the horizontal extrusions for the appropriate height and lock them in place

2
Position the top and bottom Horizontal Extrusions to the Vertical Extrusions at the appropriate height and lock the attached CBX connectors into place with a hex-key

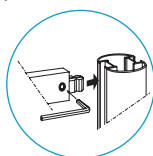

1
Attach the Vertical Extrusions to the floor bases using Insert Blocks, with set screws and a hex-key

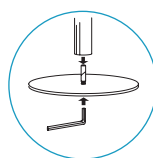

5
Position the Panel Supports symmetrically on the cables using a hex-key, and affix the Acrylic Poster & Acrylic Literature Holders. (see **ADDITIONAL RESOURCES** below for instruction links)

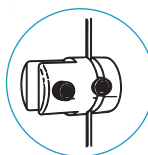

4
Install Cable Suspension Kits. (see **ADDITIONAL RESOURCES** below for instruction links)

CABLE OPTIONS

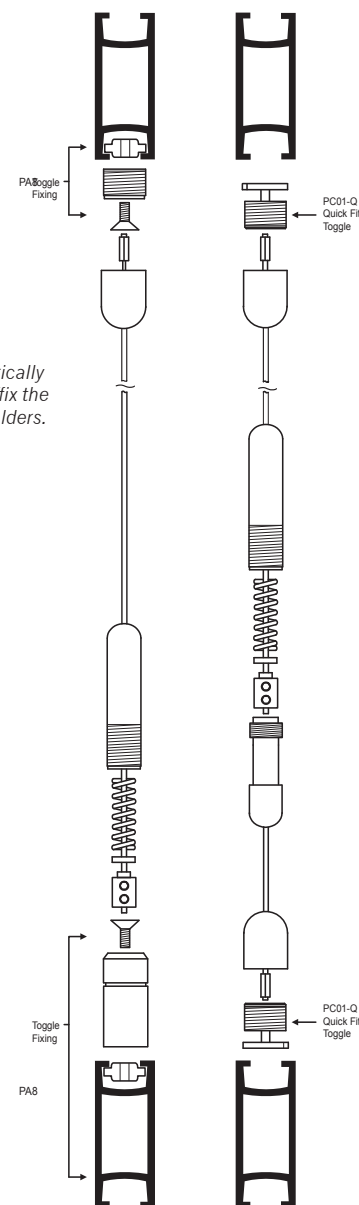

CA4 Cable Kit **CQQ Cable Kit**

Each Kit includes the Cable Kit show in the illustration. For alternate cabling options contact Customer Service.

Read instruction sheet carefully before starting assembly □ Separate all parts and check quantities □ Account for all parts before discarding any packaging materials

ADDITIONAL RESOURCE LINKS:

Reference **CA4 Cable Kit** & **CQQ Cable Kit** Installation Guides for cable assembly

Reference **CG01** & **CG03** Panel Support Installation Guides for panel support assembly

INDEX OF APPLICABLE MODELS:

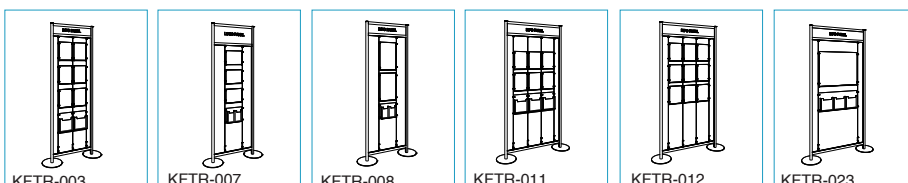

Free-Style Display Installation Guidelines

NOVADISPLAY®
INNOVATIVE DISPLAY SOLUTIONS

KFTR-028, KFTR-030 • KFTR-036

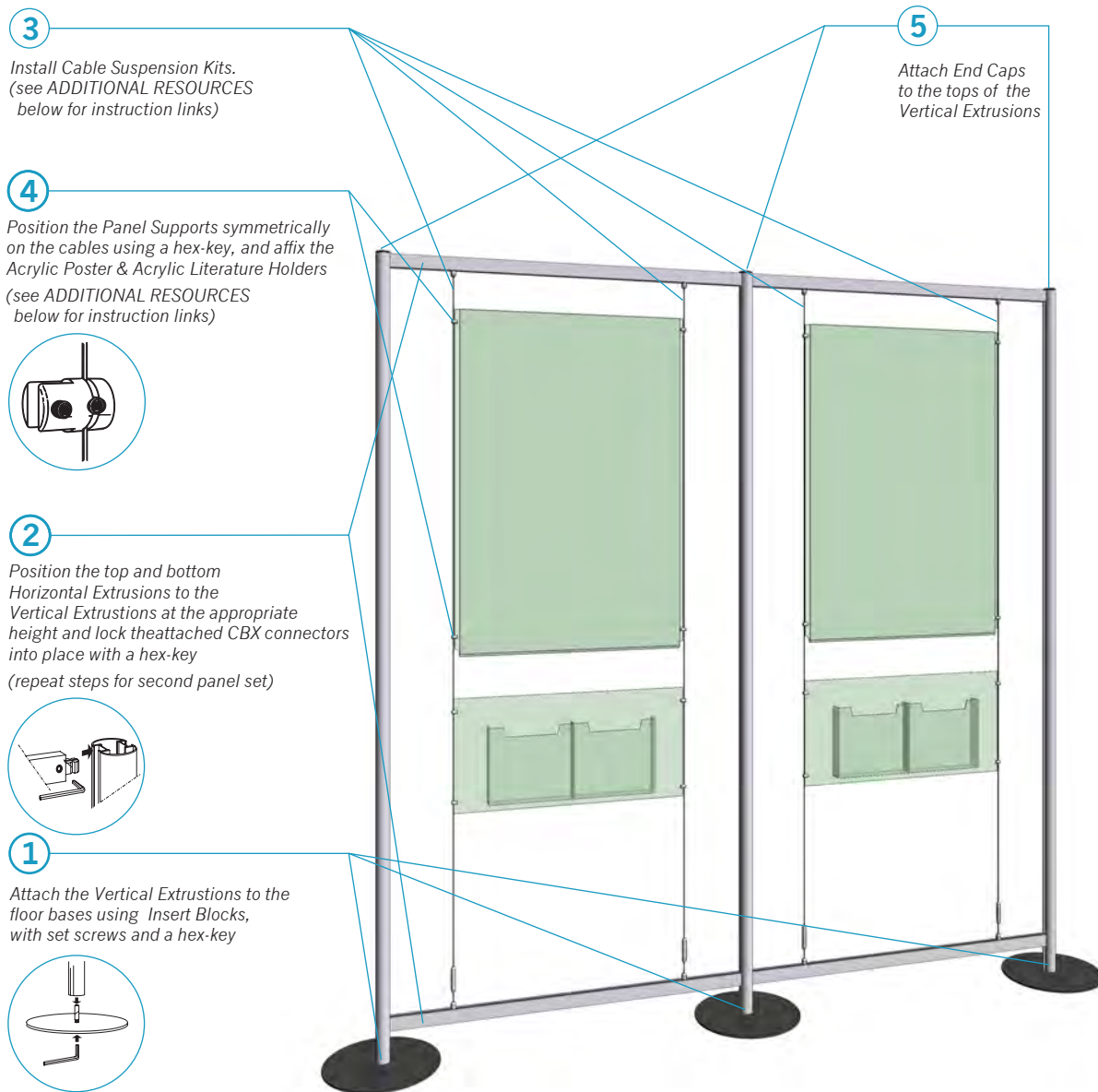

CABLE OPTIONS

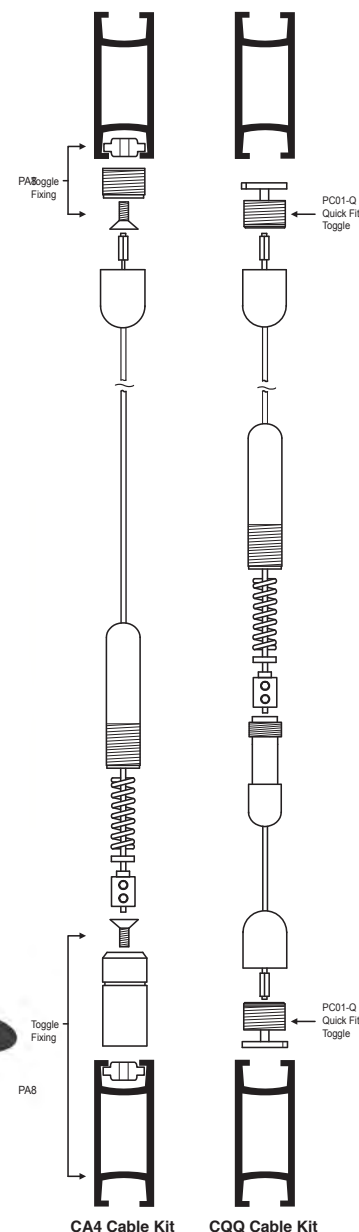

Each Kit includes the Cable Kit shown in the illustration. For alternate cabling options contact Customer Service.

Read instruction sheet carefully before starting assembly □ Separate all parts and check quantities □ Account for all parts before discarding any packaging materials

ADDITIONAL RESOURCE LINKS:

Reference **CA4 Cable Kit** & **CQQ Cable Kit** Installation Guides for cable assembly
Reference **CG01** & **CG03** Panel Support Installation Guides for panel support assembly

INDEX OF APPLICABLE MODELS:

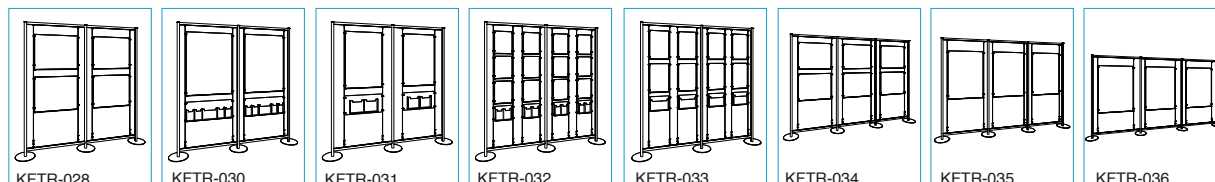

Free-Style Display Installation Guidelines

KFTR-029

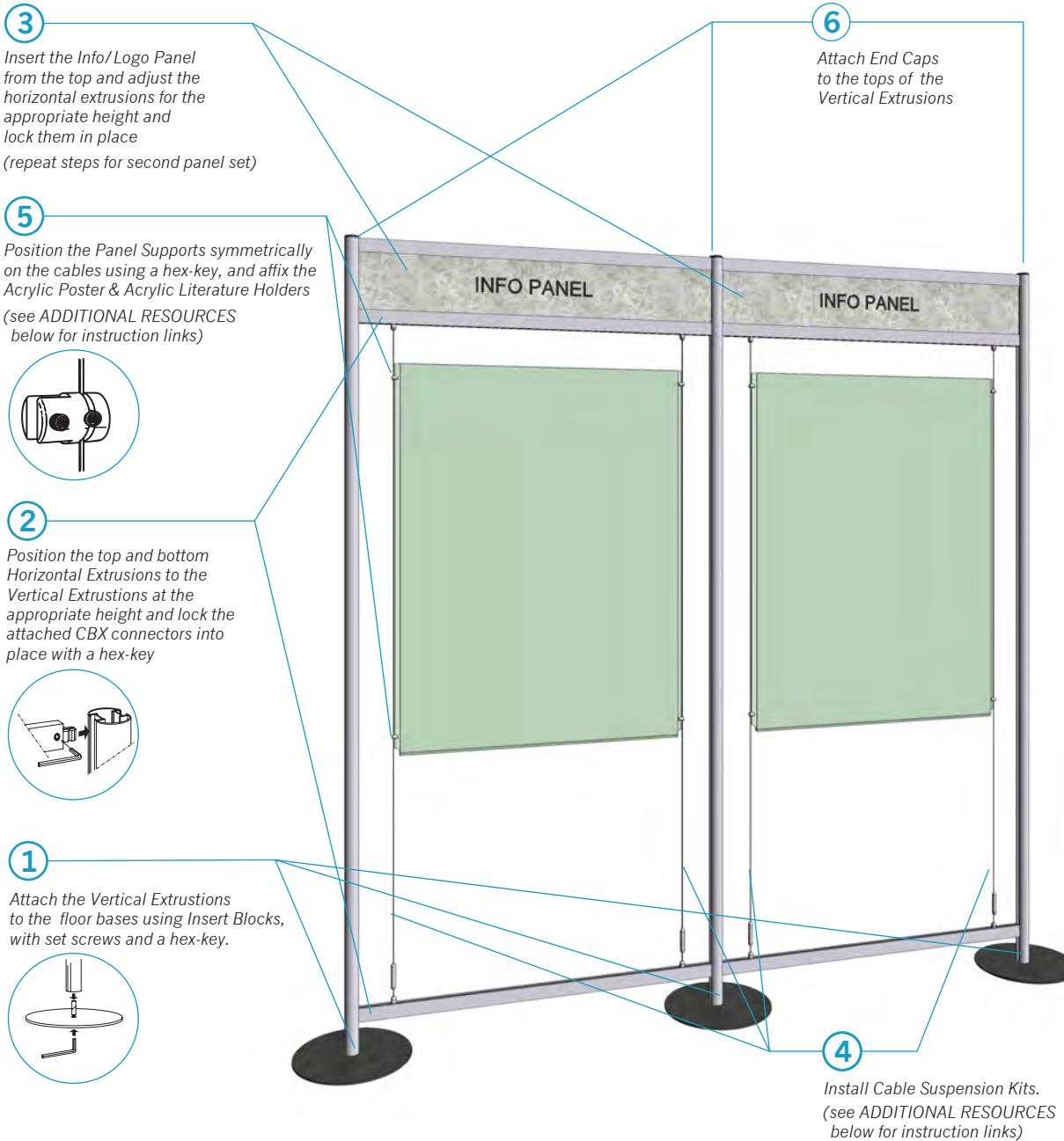

CABLE OPTIONS

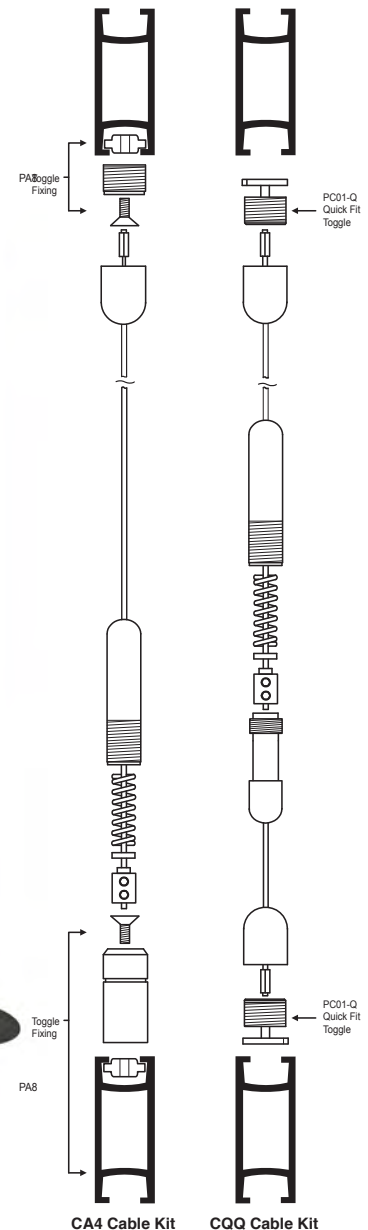

Each Kit includes the Cable Kit shown in the illustration. For alternate cabling options contact Customer Service.

Read instruction sheet carefully before starting assembly □ Separate all parts and check quantities □ Account for all parts before discarding any packaging materials

ADDITIONAL RESOURCE LINKS:

Reference [CA4 Cable Kit](#) & [CQQ Cable Kit](#) Installation Guides for cable assembly
Reference [CG01](#) & [CG03](#) Panel Support Installation Guides for panel support assembly

INDEX OF APPLICABLE MODELS:



KFTR-029

Free-Style Display Installation Guidelines

NOVADISPLAY®
INNOVATIVE DISPLAY SOLUTIONS

KFTR-038 • KFTR-039

6

Position the top Horizontal Extrusion at the appropriate height and lock the attached CBX connectors into place with a hex-key
(repeat steps 2 - 6 for second & third panel sets)

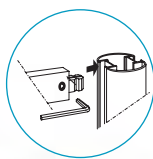

7

Attach End Caps to the tops of the Vertical Extrusions

2

Position the bottom Horizontal Extrusions at the appropriate height and lock the attached CBX connectors into place with a hex-key
(repeat steps for second & third panel sets)

3

Slide the bottom Acrylic Panel into the channel of the Vertical Extrusion & bottom Horizontal Extrusion

4

Position the middle Horizontal Extrusion at the appropriate height and lock the attached CBX connectors into place with a hex-key

5

Slide the top Acrylic Panel into the channel of the Vertical Extrusion & middle Horizontal Extrusion
(repeat steps for second & third panel sets)

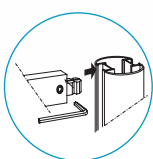

1

Attach the Vertical Extrusions to the floor bases using Insert Blocks, with set screws and a hex-key
(repeat steps for second & third panel sets)

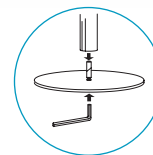

Read instruction sheet carefully before starting assembly

Separate all parts and check quantities

Account for all parts before discarding any packaging materials

ADDITIONAL RESOURCE LINKS:

Reference **CG01** & **CG03 Panel Support** Installation Guides for panel support assembly

INDEX OF APPLICABLE MODELS:

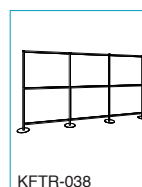

KFTR-038

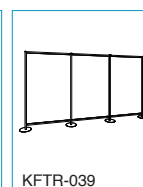

KFTR-039