

Installation Guidelines

KFPX DISPLAY STAND SERIES

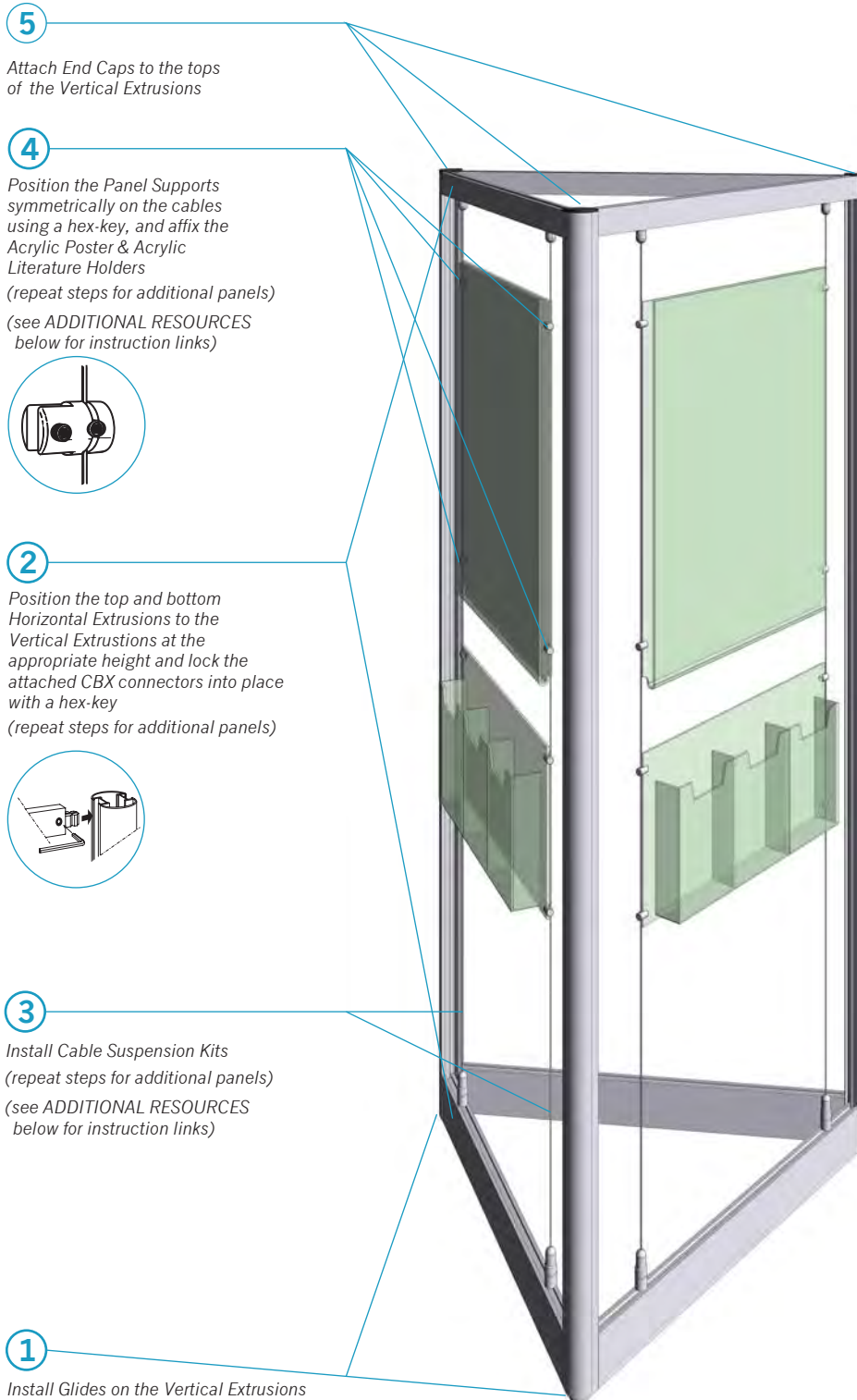

CABLE OPTIONS

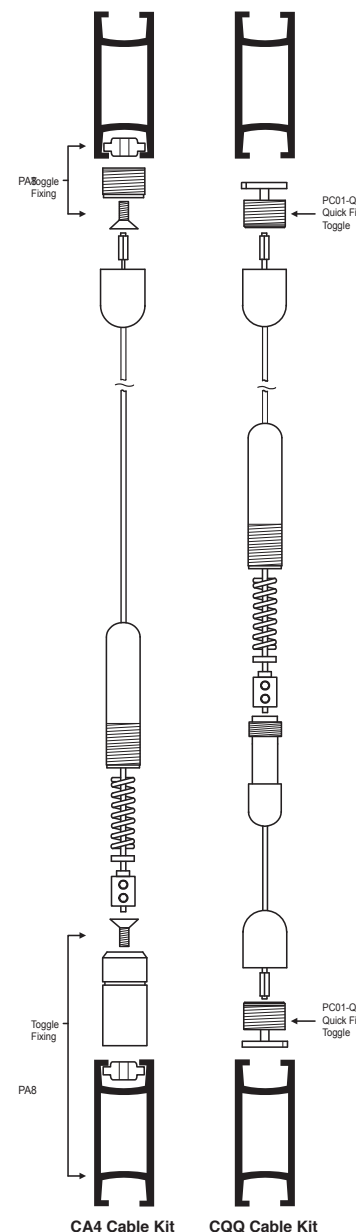

Each Kit includes the Cable Kit shown in the illustration. For alternate cabling options contact Customer Service.

Read instruction sheet carefully before starting assembly | Separate all parts and check quantities | Account for all parts before discarding any packaging materials

ADDITIONAL RESOURCE LINKS:

Reference **CA4 Cable Kit** & **CQQ Cable Kit** Installation Guides for cable assembly

Reference **CG03** & **CG04 Panel Support** Installation Guides for panel support assembly

INDEX OF APPLICABLE MODELS:

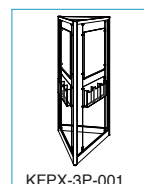

Installation Guidelines

KFPX DISPLAY STAND SERIES

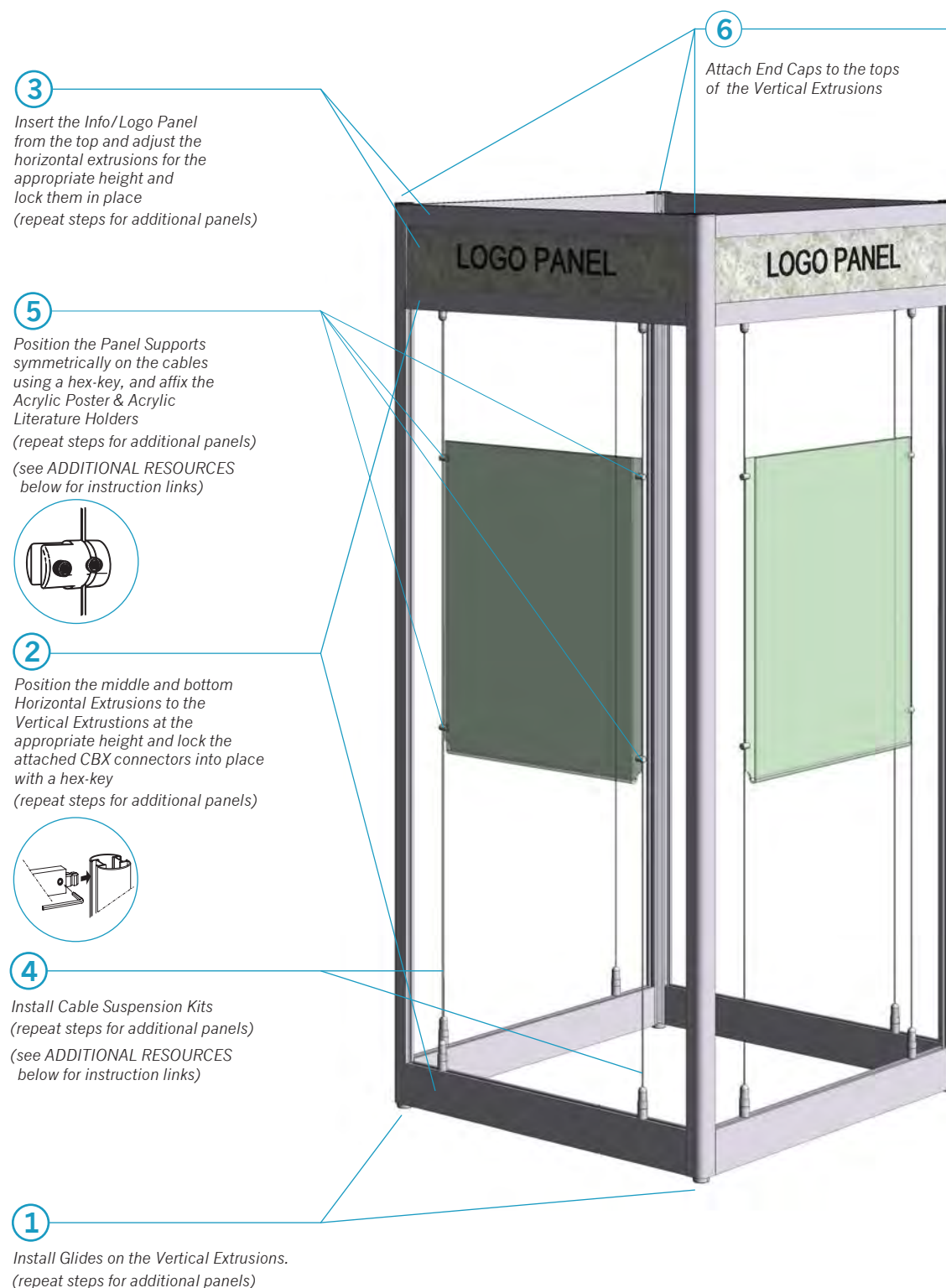

CABLE OPTIONS

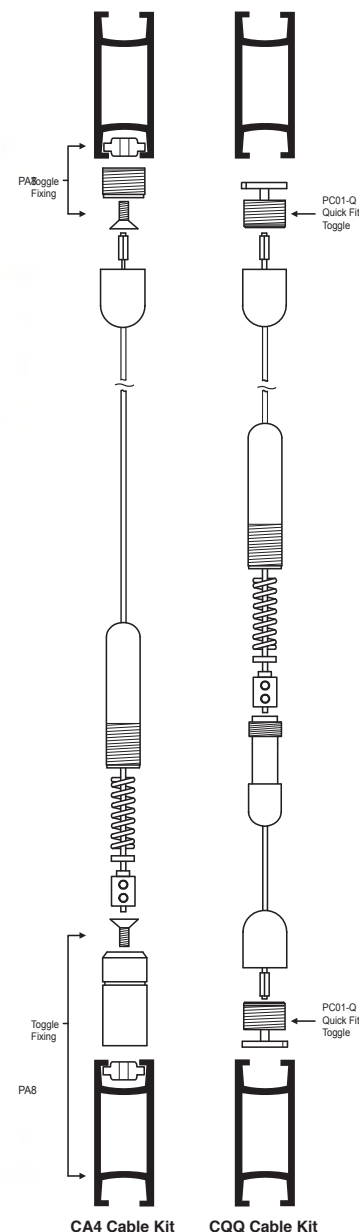

Read instruction sheet carefully before starting assembly | Separate all parts and check quantities | Account for all parts before discarding any packaging materials

ADDITIONAL RESOURCE LINKS:

Reference **CA4 Cable Kit** & **CQQ Cable Kit** Installation Guides for cable assembly
Reference **CG03** & **CG04 Panel Support** Installation Guides for panel support assembly

INDEX OF APPLICABLE MODELS:

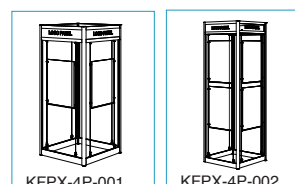

Installation Guidelines

KFPX DISPLAY STAND SERIES

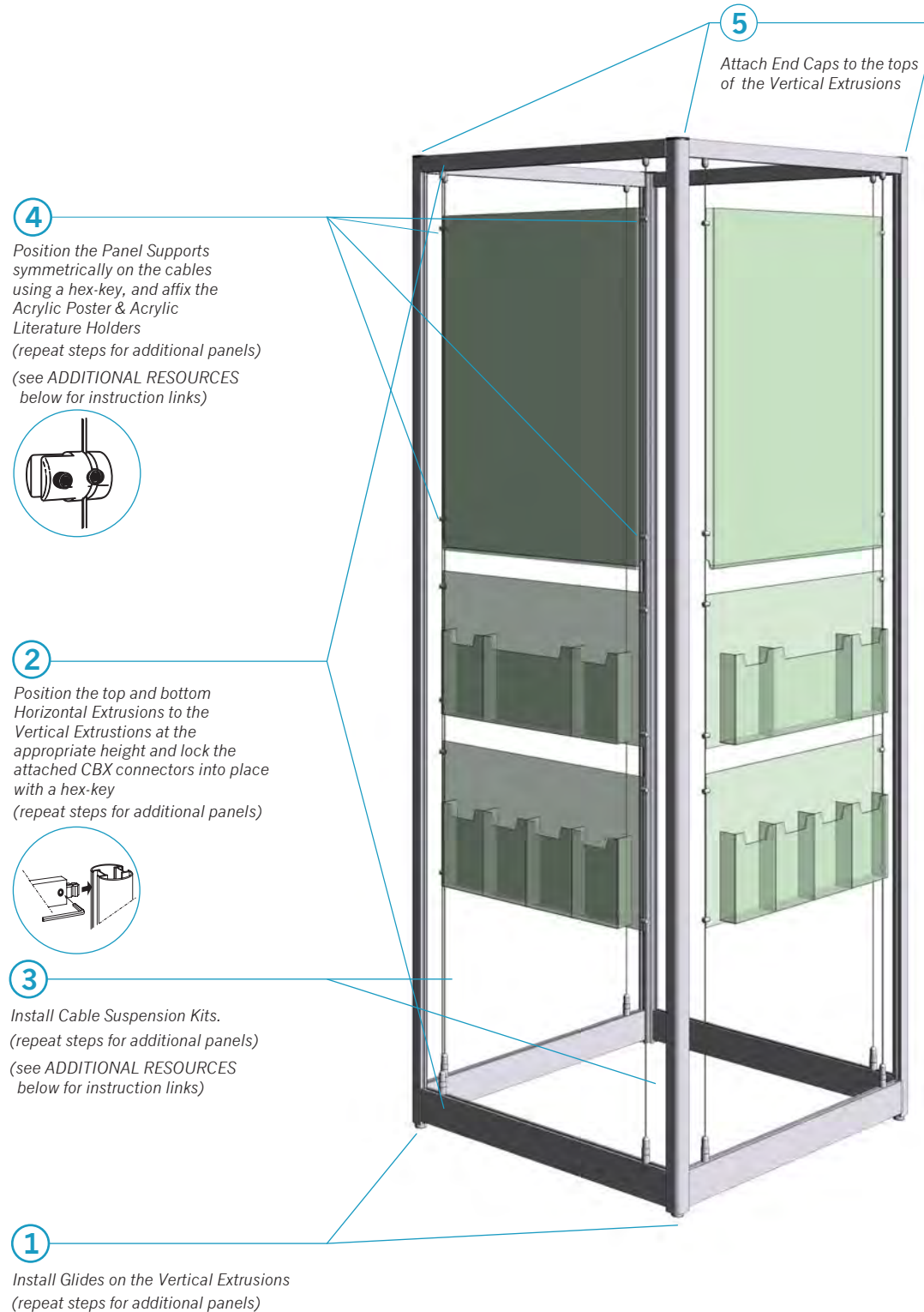

CABLE OPTIONS

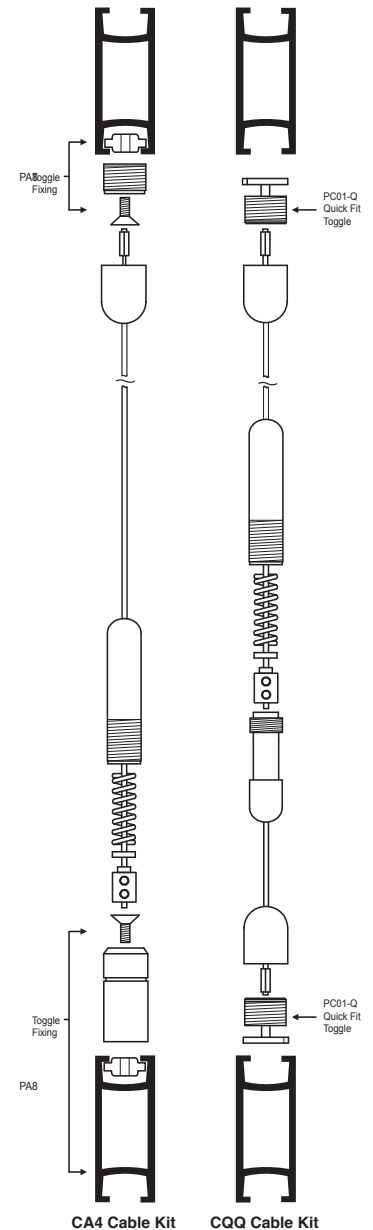

Read instruction sheet carefully before starting assembly | Separate all parts and check quantities | Account for all parts before discarding any packaging materials

ADDITIONAL RESOURCE LINKS:

Reference **CA4 Cable Kit** & **CQQ Cable Kit** Installation Guides for cable assembly
Reference **CG03** & **CG04 Panel Support** Installation Guides for panel support assembly

INDEX OF APPLICABLE MODELS:

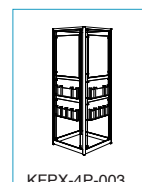

Installation Guidelines

NOVADISPLAY®
INNOVATIVE DISPLAY SOLUTIONS

KFPX DISPLAY STAND SERIES

4

Attach End Caps to the tops of the Vertical Extrusions

3

Insert the Acrylic Panel from the top and attach the top Horizontal Extrusion, and lock in place (repeat steps for additional panels)

2

Position the bottom Horizontal Extrusion to the Vertical Extrusions at the appropriate height and lock the attached CBX connectors into place with a hex-key (repeat steps for additional panels)

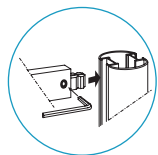

1

Install Glides on the Vertical Extrusions (repeat steps for additional panels)

Read instruction sheet carefully before starting assembly | Separate all parts and check quantities | Account for all parts before discarding any packaging materials

ADDITIONAL RESOURCE LINKS:

Reference **CA4 Cable Kit** & **CQQ Cable Kit** Installation Guides for cable assembly

Reference **CG03** & **CG04 Panel Support** Installation Guides for panel support assembly

INDEX OF APPLICABLE MODELS:

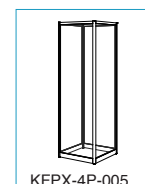
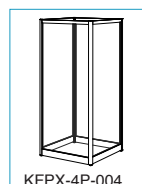

Installation Guidelines

KFPX DISPLAY STAND SERIES

CABLE OPTIONS

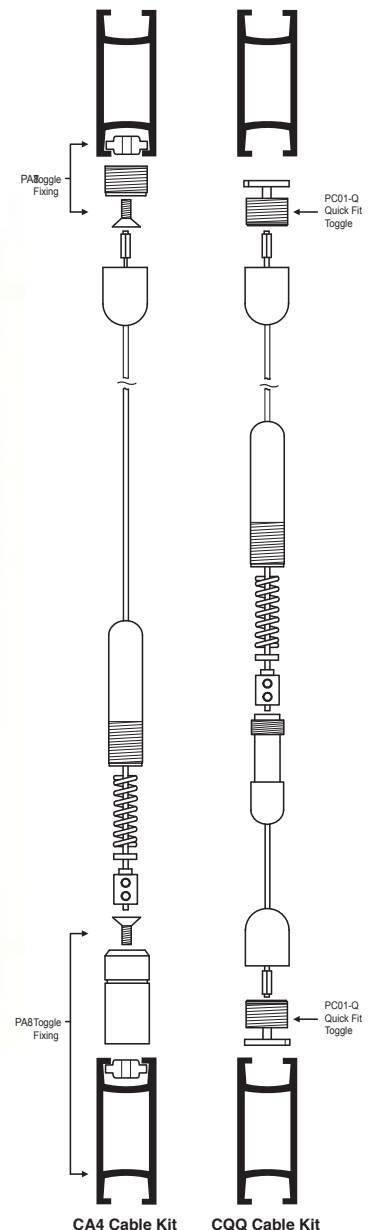
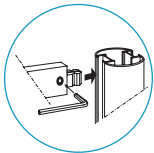
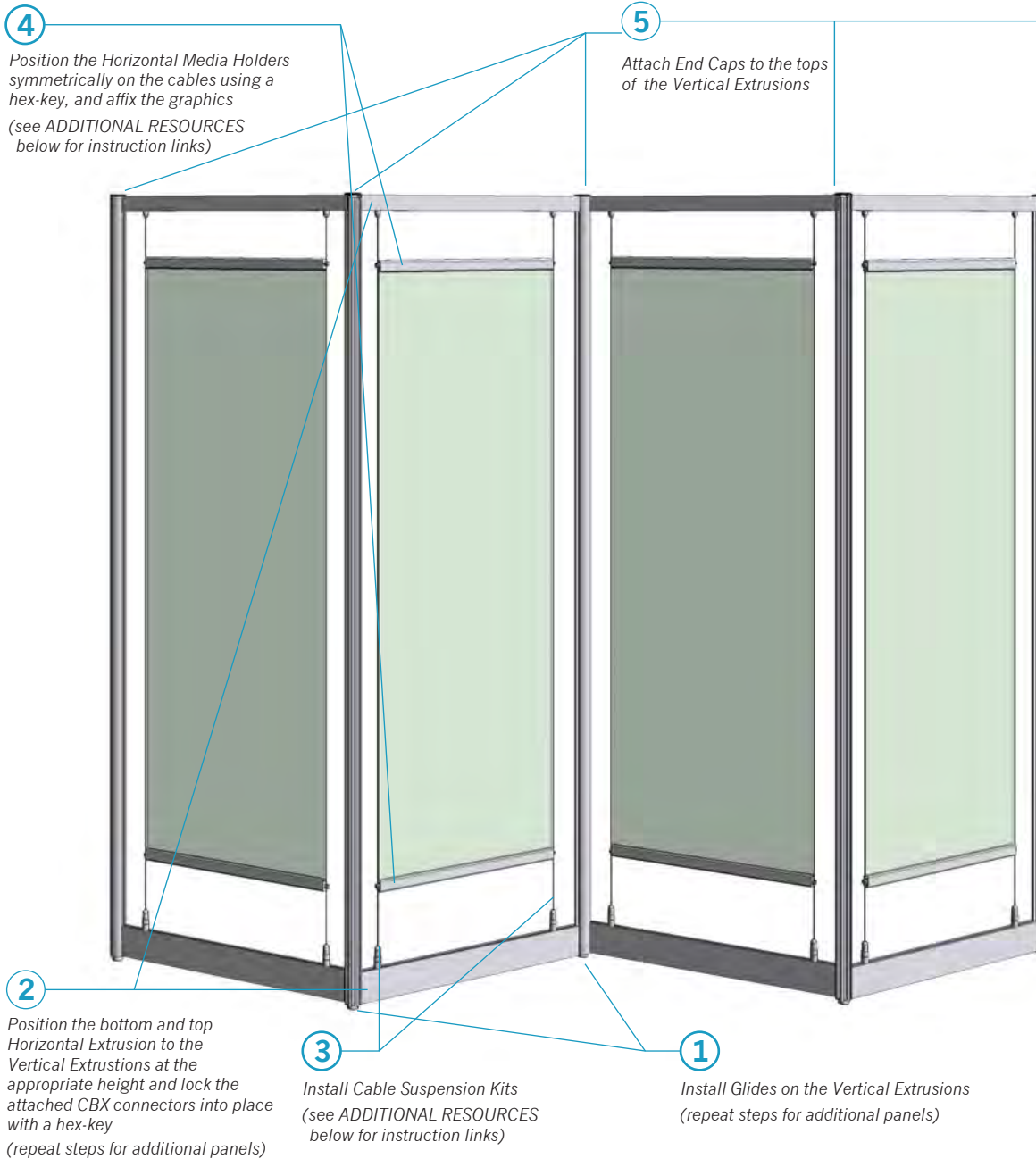

Each Kit includes the Cable Kit shown in the illustration. For alternate cabling options contact Customer Service.

Read instruction sheet carefully before starting assembly | Separate all parts and check quantities | Account for all parts before discarding any packaging materials

ADDITIONAL RESOURCE LINKS:

Reference **CA4 Cable Kit** & **CQQ Cable Kit** Installation Guides for cable assembly
Reference **CS03** & **CS04 Panel Support** Installation Guides for panel support assembly

INDEX OF APPLICABLE MODELS:

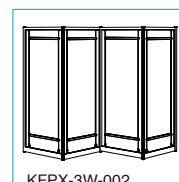

Installation Guidelines

KFPX DISPLAY STAND SERIES

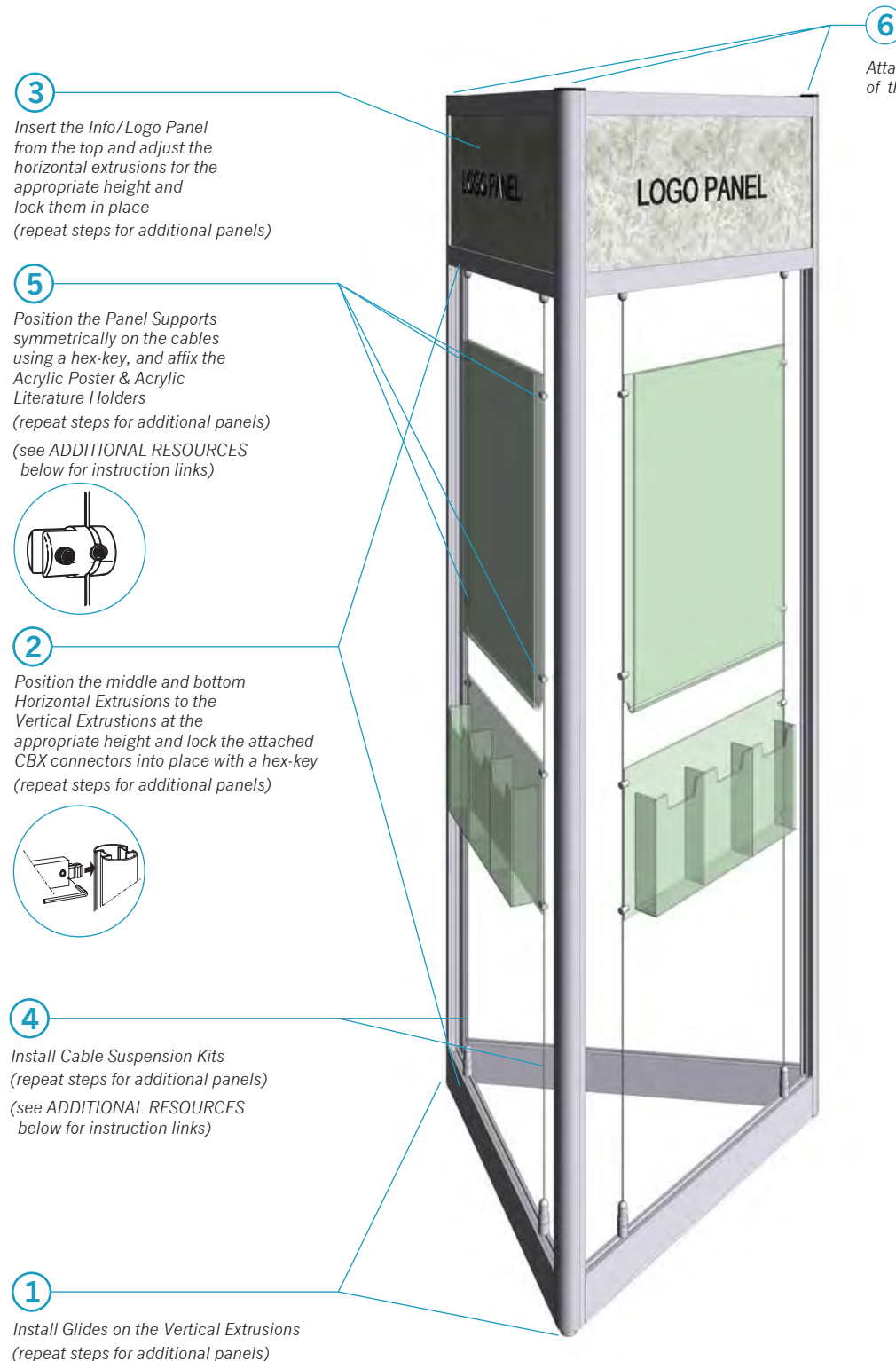

CABLE OPTIONS

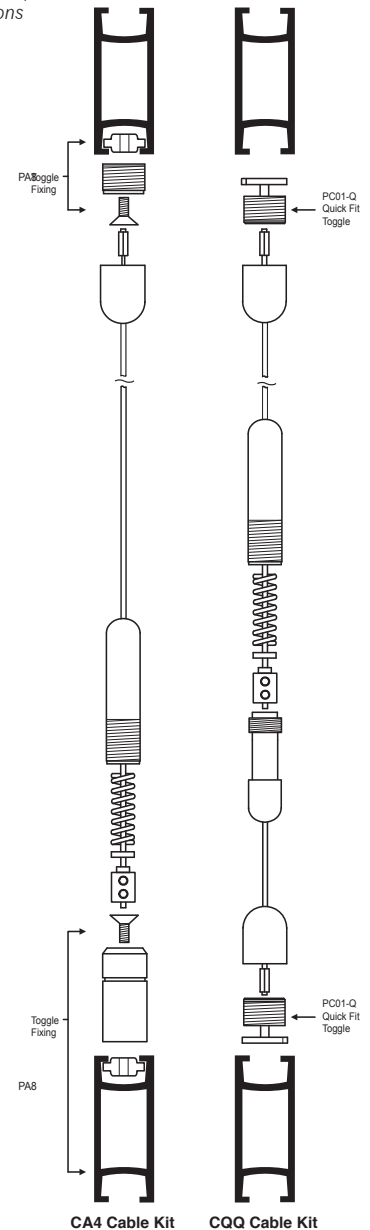

Read instruction sheet carefully before starting assembly | Separate all parts and check quantities | Account for all parts before discarding any packaging materials

ADDITIONAL RESOURCE LINKS:

Reference **CA4 Cable Kit** & **CQQ Cable Kit** Installation Guides for cable assembly
Reference **CG03** & **CG04 Panel Support** Installation Guides for panel support assembly

INDEX OF APPLICABLE MODELS:

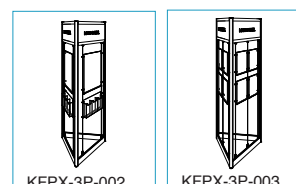

Installation Guidelines

KFPX DISPLAY STAND SERIES

3

Insert the Acrylic Panel from the top and attach the top Horizontal Extrusion and lock in place (repeat steps for additional panels)

4

Attach End Caps to the tops of the Vertical Extrusions

2

Position the bottom Horizontal Extrusion to the Vertical Extrusions at the appropriate height and lock the attached CBX connectors into place with a hex-key (repeat steps for additional panels)

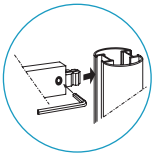

1

Install Glides on the Vertical Extrusions (repeat steps for additional panels)

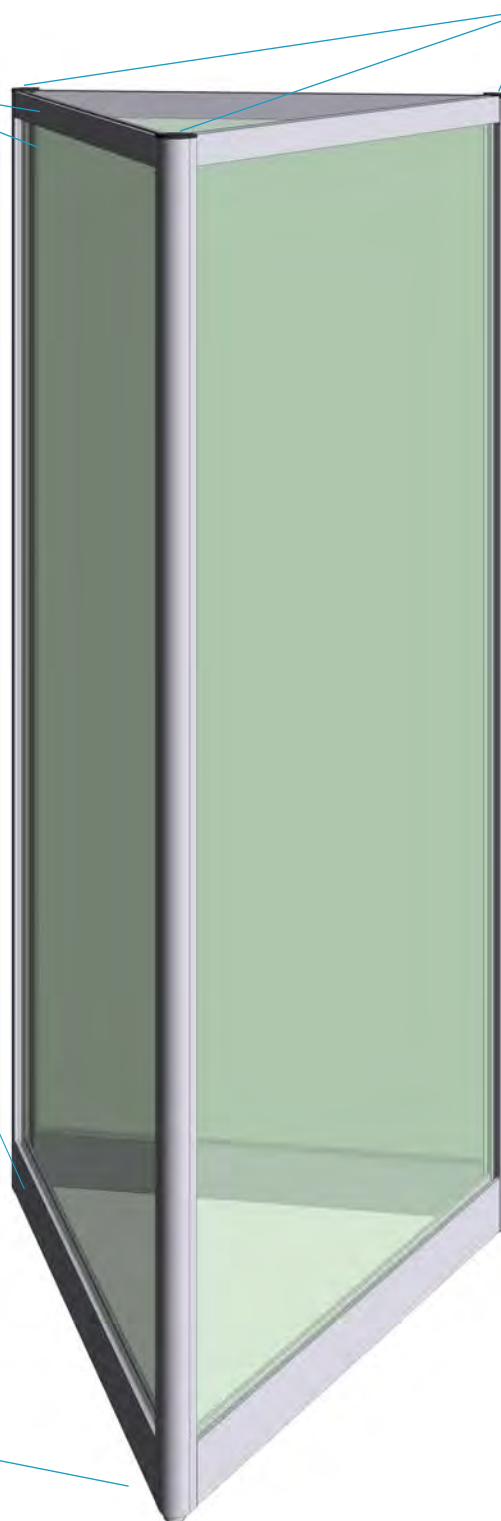

Read instruction sheet carefully before starting assembly | Separate all parts and check quantities | Account for all parts before discarding any packaging materials

INDEX OF APPLICABLE MODELS:

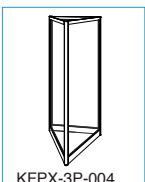

KFPX-3P-004

Installation Guidelines

KFPX DISPLAY STAND SERIES

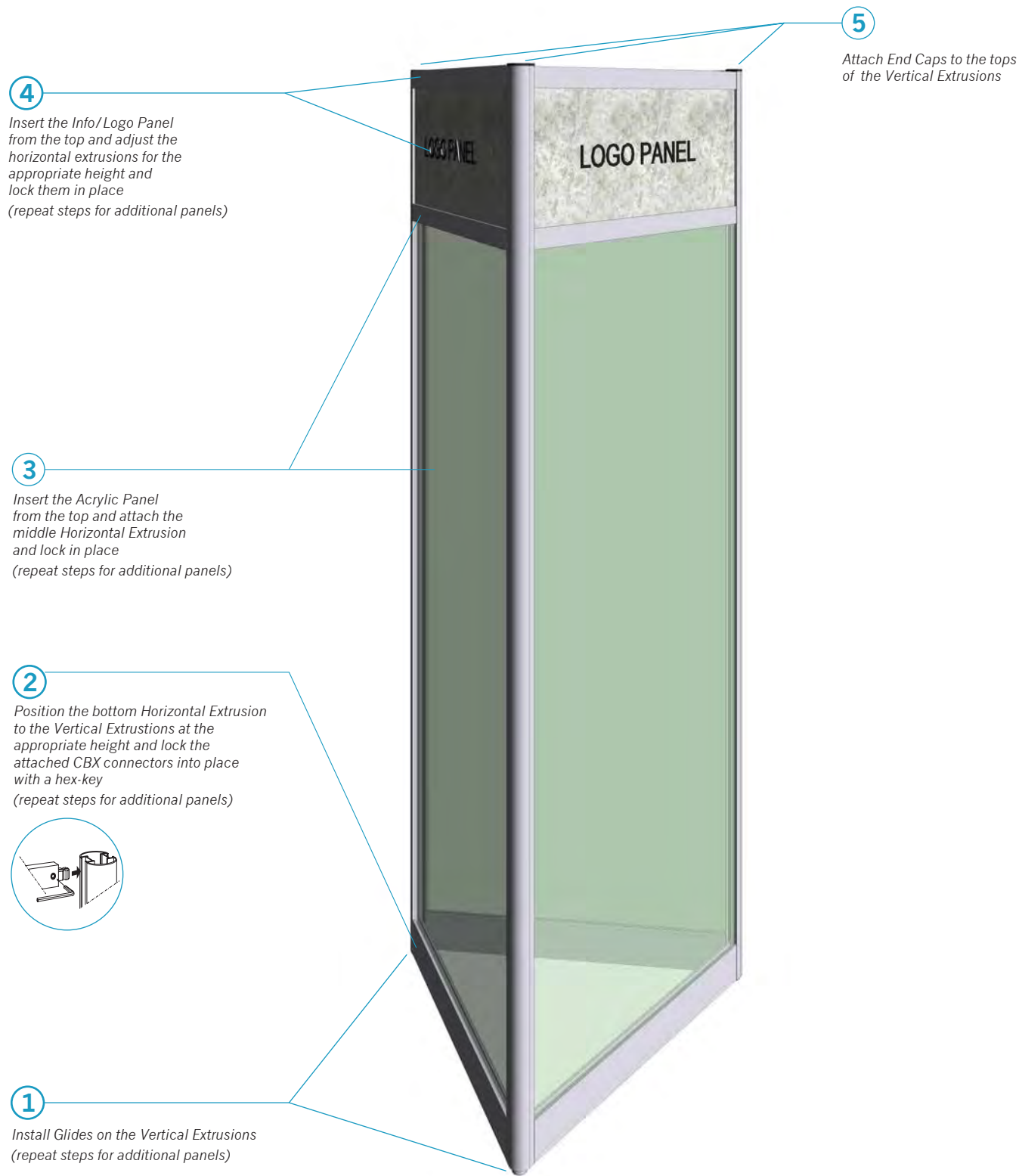

Read instruction sheet carefully before starting assembly | Separate all parts and check quantities | Account for all parts before discarding any packaging materials

INDEX OF APPLICABLE MODELS:

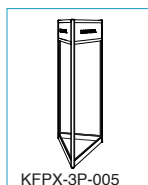

Installation Guidelines

KFPX DISPLAY STAND SERIES

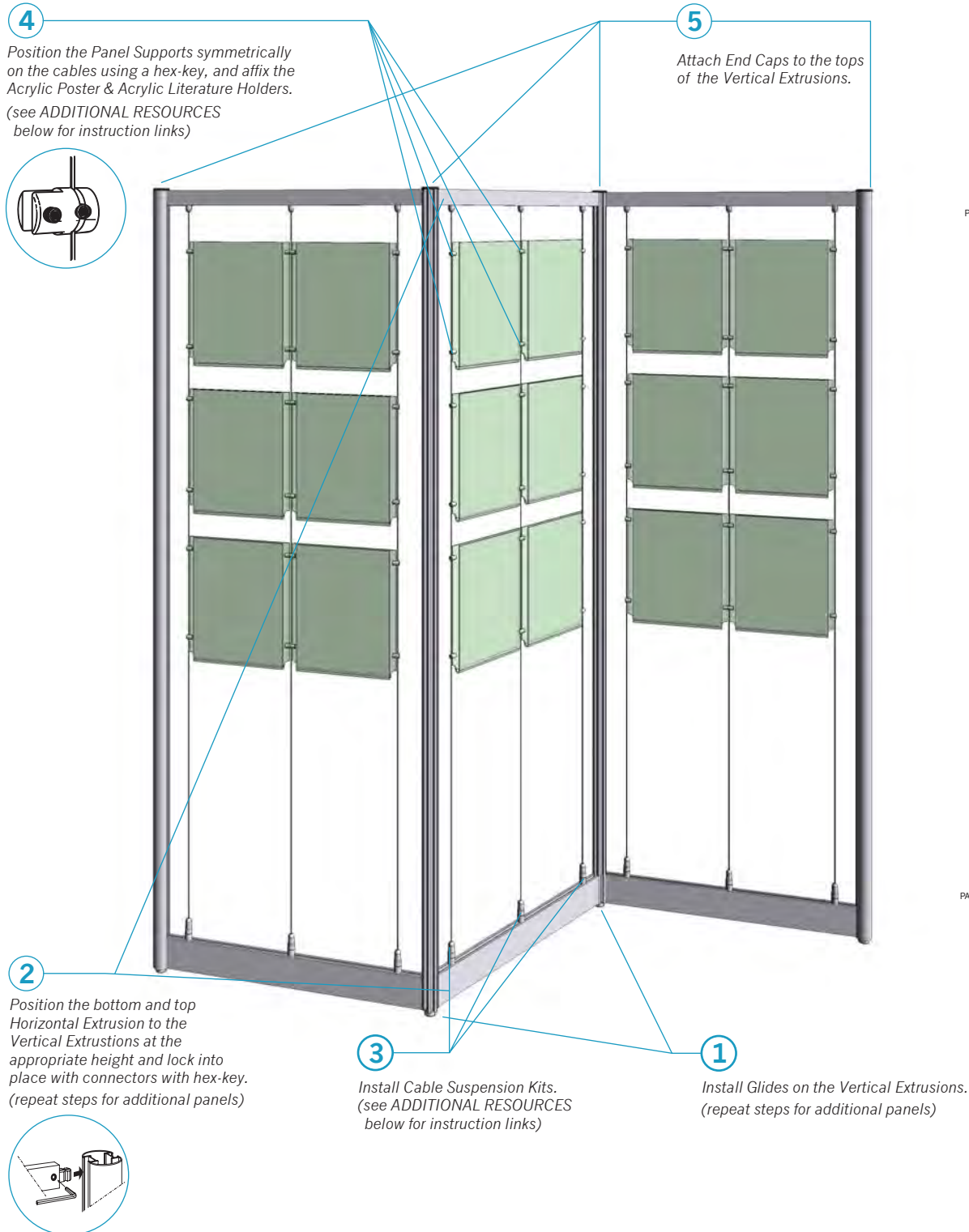

CABLE OPTIONS

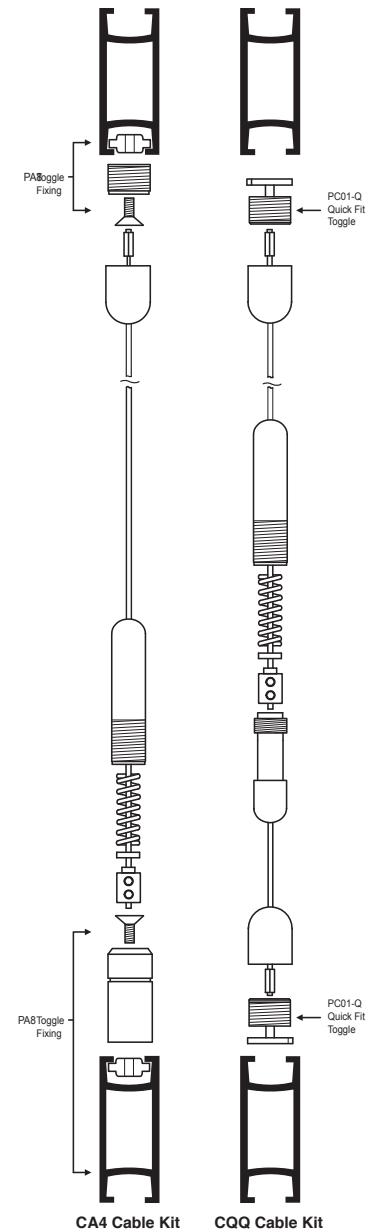

CA4 Cable Kit CQQ Cable Kit

Each Kit includes the Cable Kit shown in the illustration. For alternate cabling options contact Customer Service.

Read instruction sheet carefully before starting assembly | Separate all parts and check quantities | Account for all parts before discarding any packaging materials

ADDITIONAL RESOURCE LINKS:

Reference **CA4 Cable Kit** & **CQQ Cable Kit** Installation Guides for cable assembly
Reference **CG03** & **CG04 Panel Support** Installation Guides for panel support assembly

INDEX OF APPLICABLE MODELS:

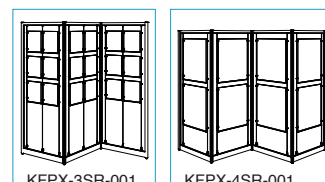

Installation Guidelines

KFPX DISPLAY STAND SERIES

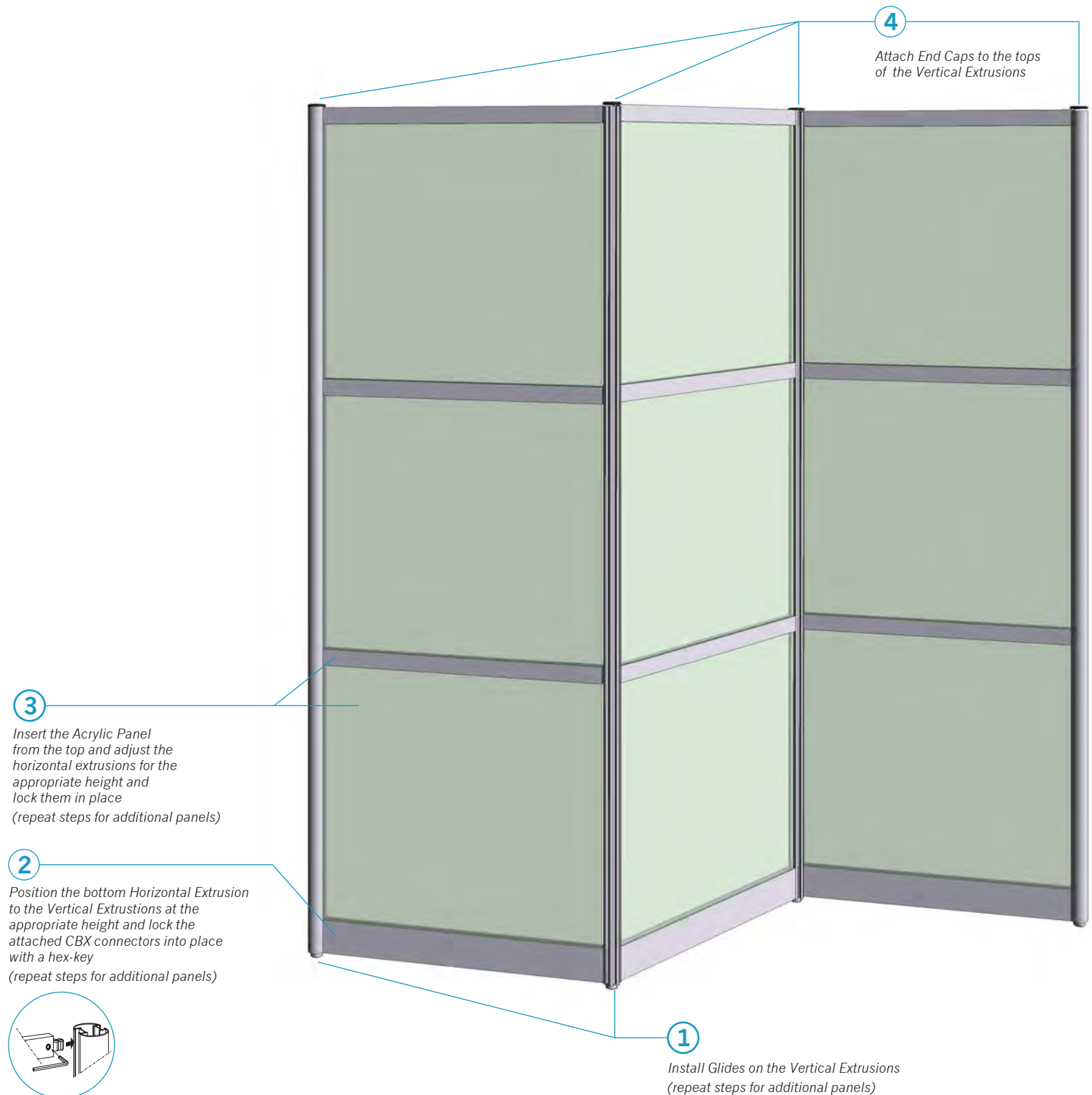

Read instruction sheet carefully before starting assembly | Separate all parts and check quantities | Account for all parts before discarding any packaging materials

INDEX OF APPLICABLE MODELS:

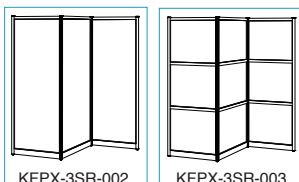

Installation Guidelines

KFPX DISPLAY STAND SERIES

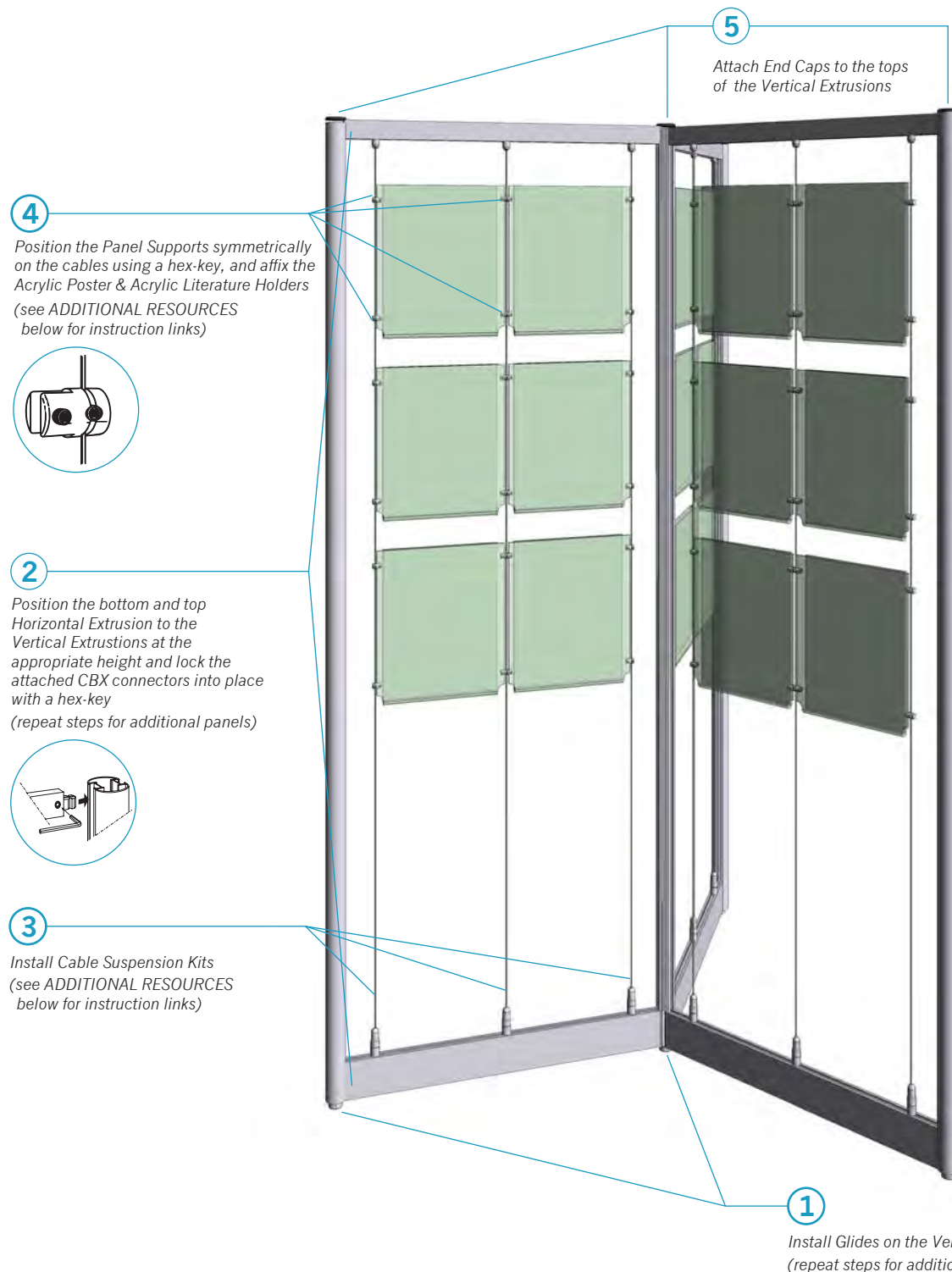

CABLE OPTIONS

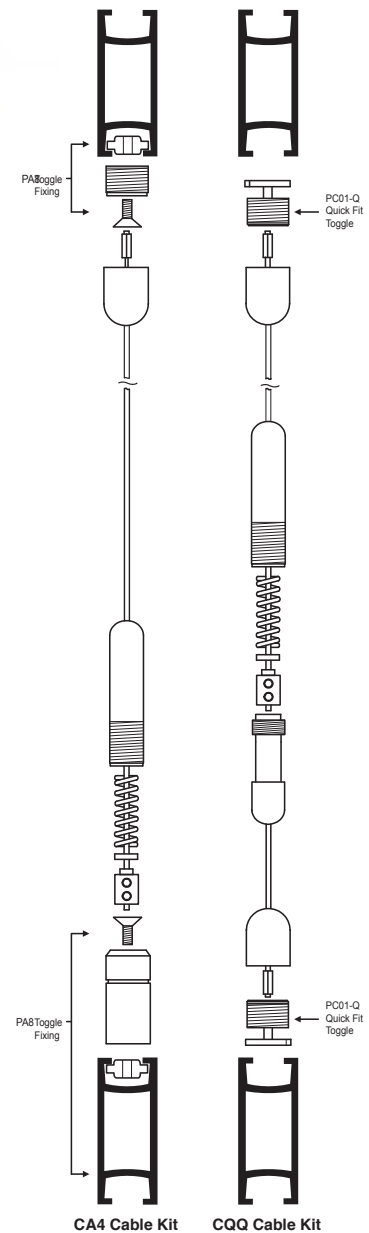

Read instruction sheet carefully before starting assembly | Separate all parts and check quantities | Account for all parts before discarding any packaging materials

ADDITIONAL RESOURCE LINKS:

Reference **CA4 Cable Kit** & **CQQ Cable Kit** Installation Guides for cable assembly
Reference **CG03** & **CG04 Panel Support** Installation Guides for panel support assembly

INDEX OF APPLICABLE MODELS:

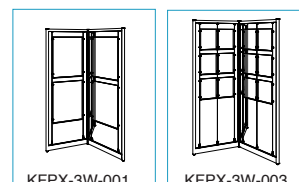

Installation Guidelines

KFPX DISPLAY STAND SERIES

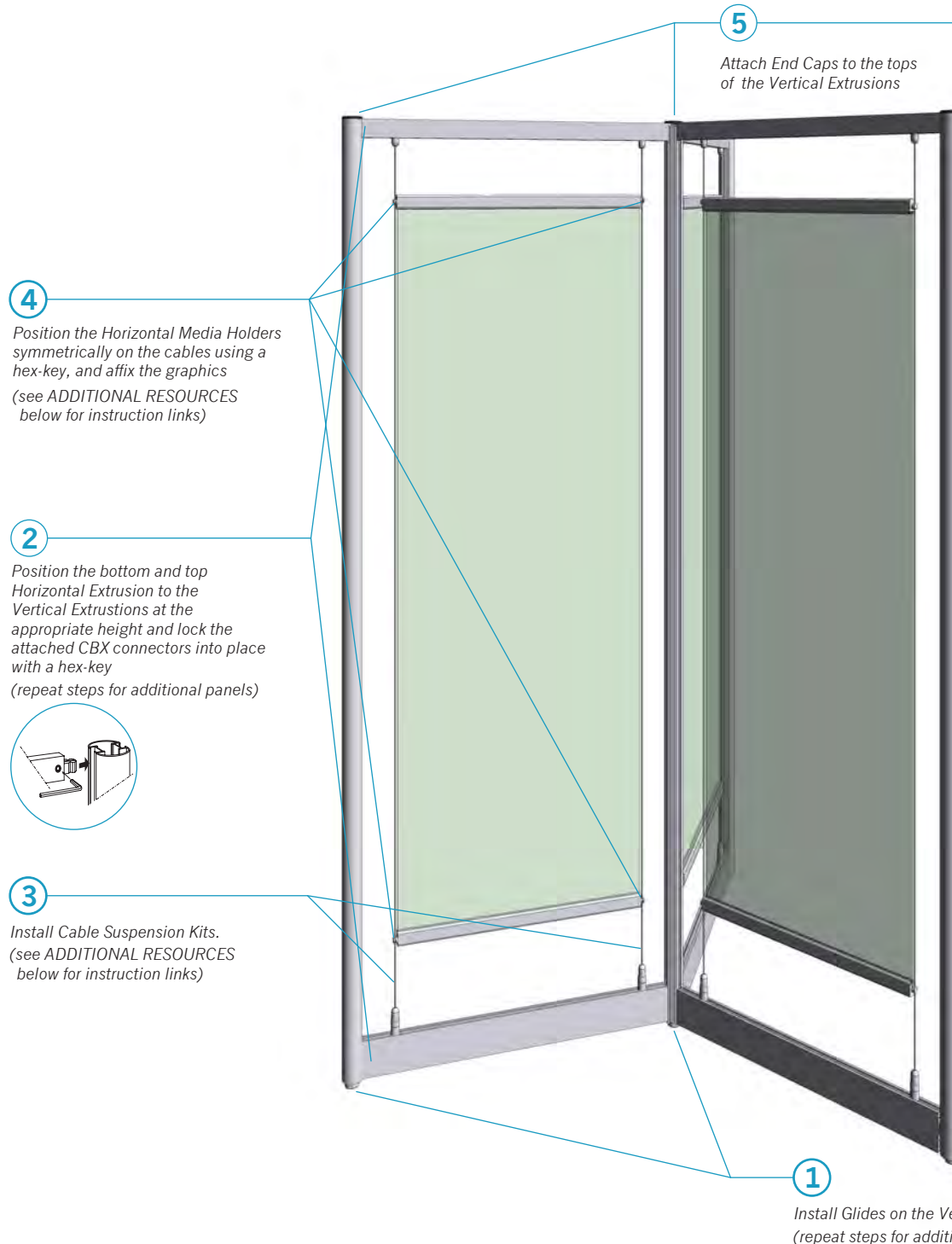

CABLE OPTIONS

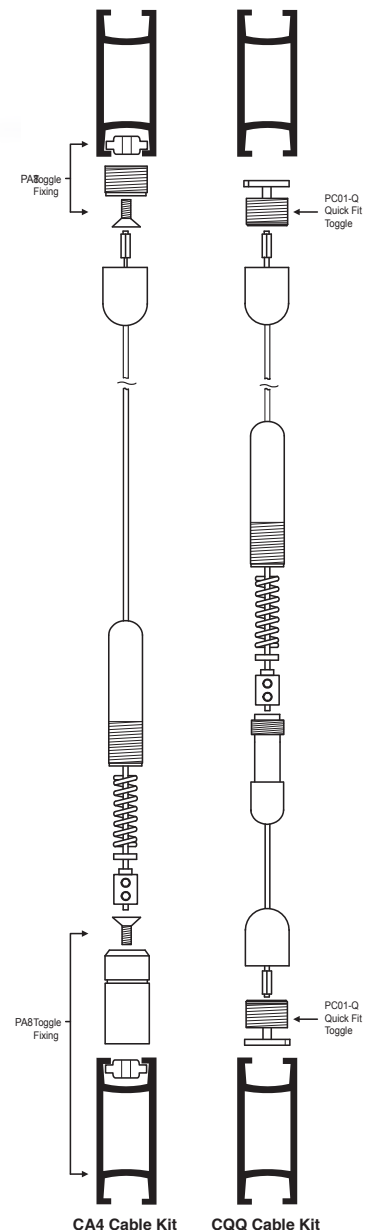

Each Kit includes the Cable Kit show in the illustration. For alternate cabling options contact Customer Service.

Read instruction sheet carefully before starting assembly | Separate all parts and check quantities | Account for all parts before discarding any packaging materials

ADDITIONAL RESOURCE LINKS:

Reference **CA4 Cable Kit** & **CQQ Cable Kit** Installation Guides for cable assembly

INDEX OF APPLICABLE MODELS:

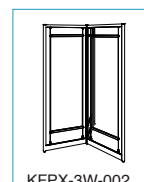

KFPX-3W-002

Installation Guidelines

KFPX DISPLAY STAND SERIES



Read instruction sheet carefully before starting assembly | Separate all parts and check quantities | Account for all parts before discarding any packaging materials

INDEX OF APPLICABLE MODELS:

