

Glass Shelving Fixing - RG15-10 Support Installation

- 1) Attach a clamp support to each corner of the glass shelf at 3/4" - 1" distance from edge (fig 1).

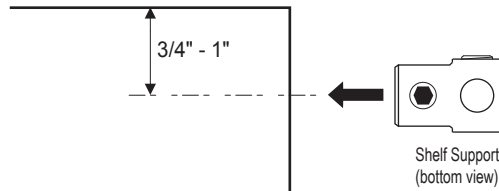
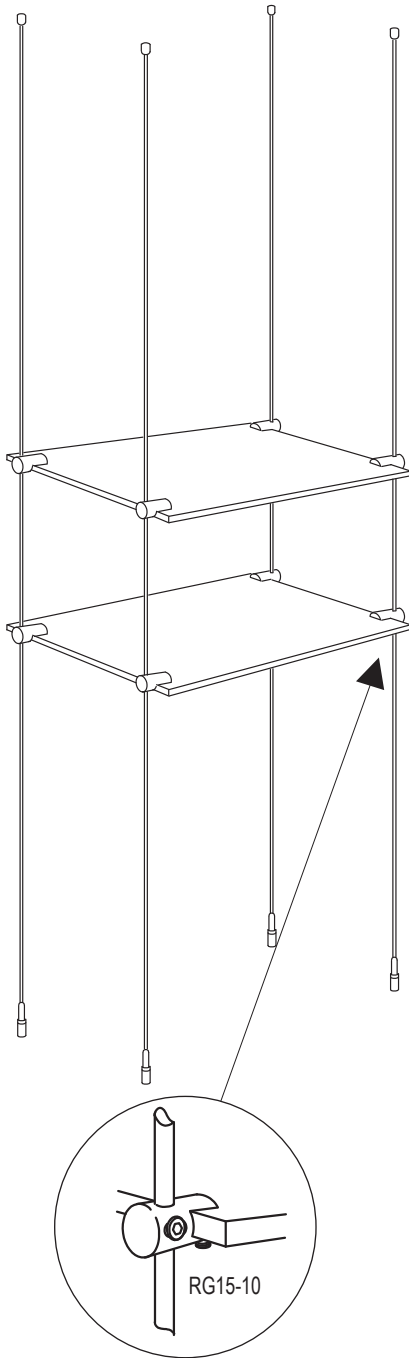
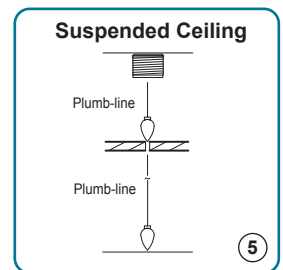
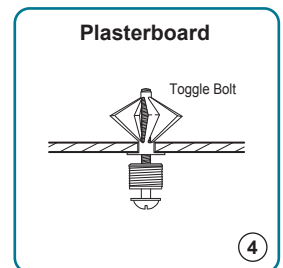
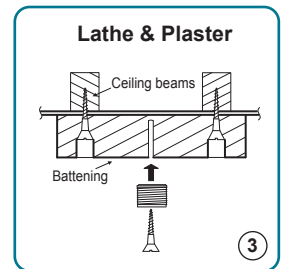
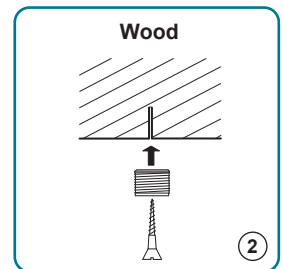
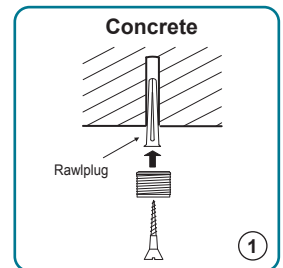

fig 1

- 2) **Mark rod positions on floor area** - Lay shelves on floor and mark rod positions, or use measurements. With the use of a plumb line mark, and fix rods to ceiling (ensuring that fixings are secure).
- 3) Install rods as per "**Rod Fixing Instructions**" for **RAS-10** supplied.
- 4) **Shelf Fitting** - As a guideline: the lowest shelf should be fixed approx. 24" from the floor, and subsequent shelves approx 12" apart.
- 5) **Fix shelf to rods** - Adjust shelf to a horizontal position; preferably with a spirit level. Repeat procedure for other shelves.



INSTALLATION TIPS



Options - Side & Front Shelf Clamp Fixing

