

# Installation Guidelines



**A - (1) Left side miter - cut split rail**



**B- (1) Right side miter-cut split rail**



**C- (2) Vertical 21.25" double rail**



**D- (2) Vertical 15.25" double rail**



**E- (2) Horizontal 51.81" double rail**

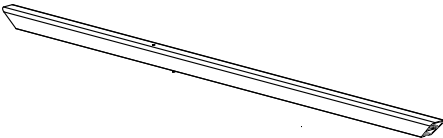

**F-Top miter cut rail**



**G- Bottom miter cut rail**

  
J (4) Short screws

  
K (8) Long screws

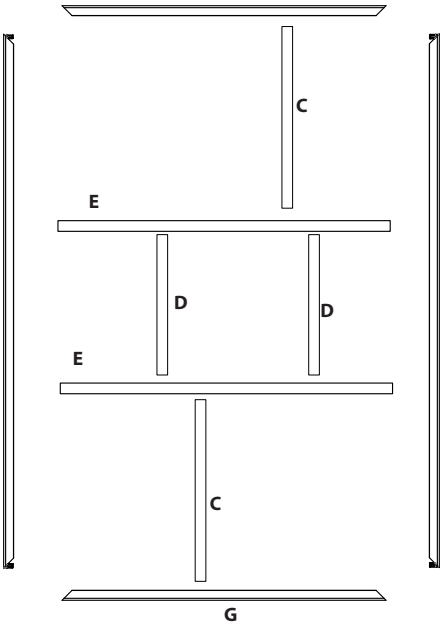

# Installation Guidelines

**\*Phillips head Screwdriver required for assembly**

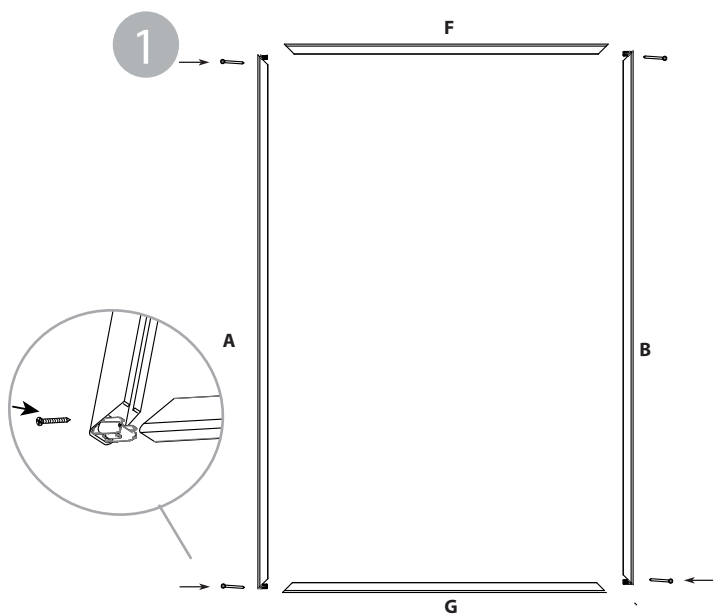

1. Connect corners of frame rails "A" to "F" and "A" to "G" with screw "J"
2. Repeat step to connect rail "B" to "F" and "G"

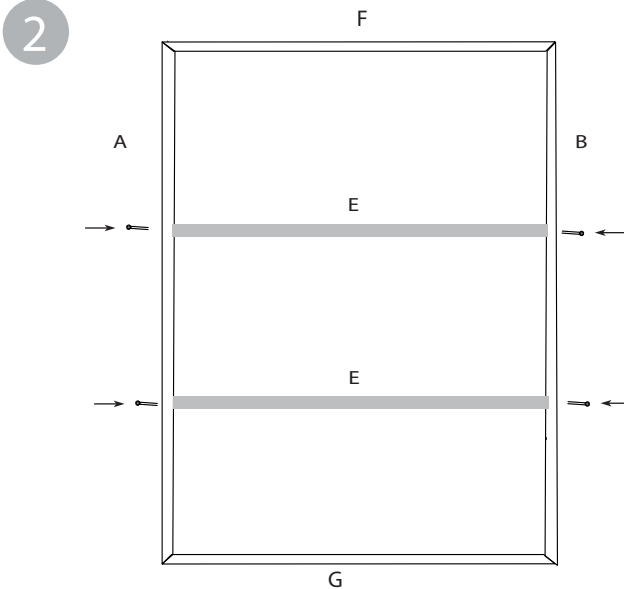

1. Attach double rails "E" to Rails "A" & "B"  
Align hole in screw carriage to the center hole of the Solid rail "A" and connect to split rail "B"  
Repeat for bottom rail.

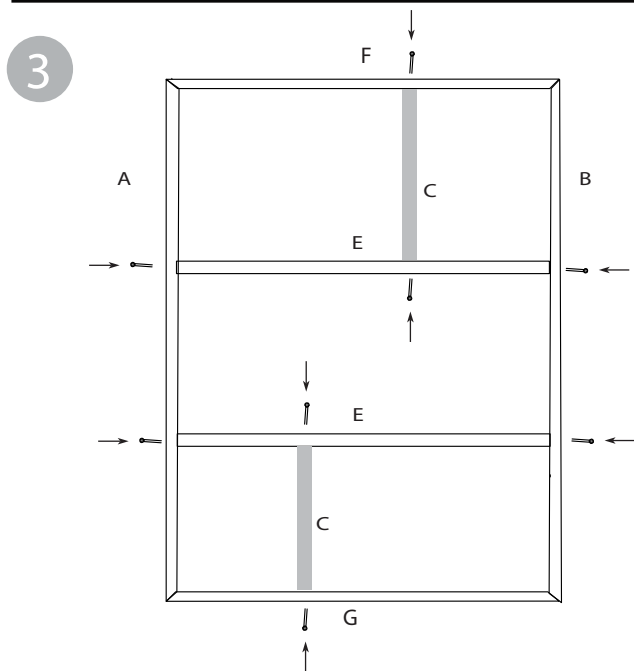

1. Attach the first vertical double rail "C" to Rails "F" & "E"  
Attach the second vertical double rail "C" to Rails "E" & "G"

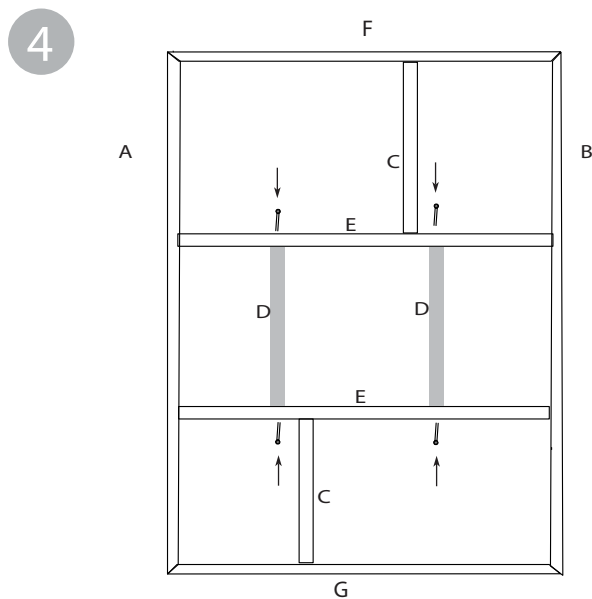

1. Attach Rails "D" to rails "E"

# Installation Guidelines

**NOVADISPLAY**  
INNOVATIVE DISPLAY SOLUTIONS

Newbury Multisystem

800.753.9688 • [www.novadisplay.com](http://www.novadisplay.com)

**\*Phillips head Screwdriver required for assembly**

How To  
Mount  
On Wall

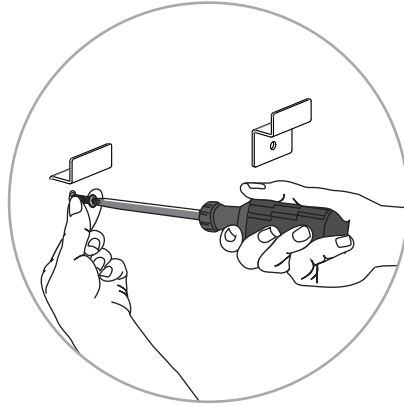

Mark and level before installing hangers.

Use Molly Anchors for drywall or other hollow surface installations (predrilling 3/16" holes is necessary).

After installing hangers, hang frame on the tabs.

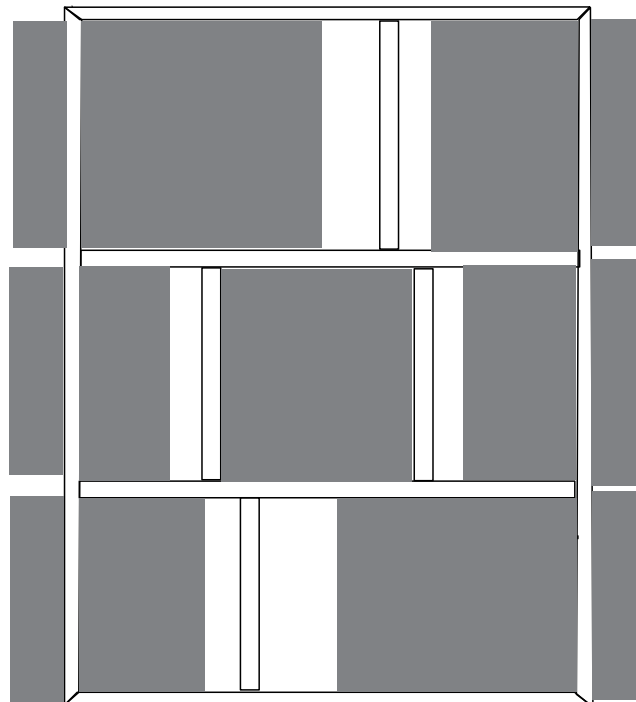

Insert Graphics