

# Installation Guidelines

**NOVA DISPLAY®**  
INNOVATIVE DISPLAY SOLUTIONS

1.5mm Cable Display Systems

800.753.9688 • www.novadisplay.com

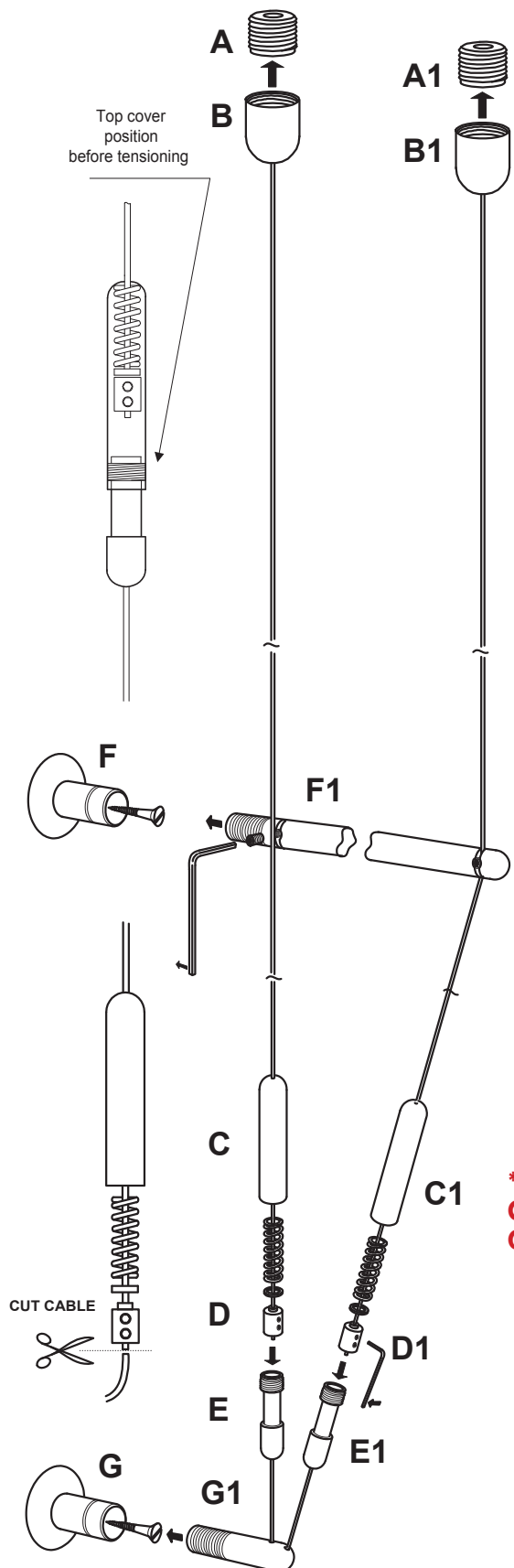

## INSTALLATION TIPS

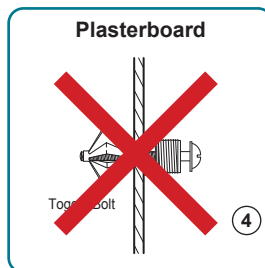
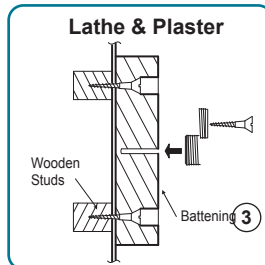
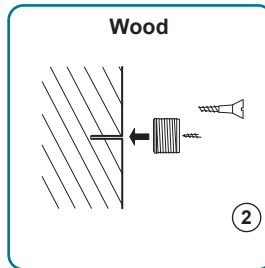
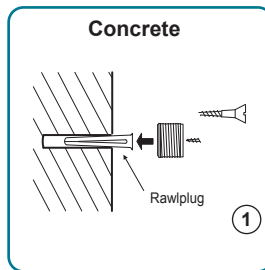

## Ceiling to Wall (C2CW-15/30) Cable Installation

**IMPORTANT:** It is essential to check that the top ceiling fixings are strong enough to take the weight of the items being displayed, while allowing for the tension in the cables.

- 1) Affix fittings (A-A1) to ceiling:
  - for wooden ceilings use a wood screw.
  - for cavity ceilings use a spring toggle bolt.
  - for solid ceilings use a rawl plug and screw.
- 2) Screw fittings (B-B1) to fittings (A-A1).
- 3) Using a plumb-line, descend from (A), and affix fittings (G-G1) to wall using appropriate type of fixing.
- 4) Attach the wall bracket (F-F1) to the wall at a respective distance from the bottom fixing (G) to form a regular triangle as shown in the diagram below.
- 5) Slacken the set screws on the wall bracket (F1) to loosen the front and back cables.
- 6) Separate the two sections of parts (C-C1) and (E-E1), and loosen the grub screws in the small brass pieces (D-D1) using the Allen key provided, and slide fittings up the cable to the desire length. (Do not remove from cable).
- 7) Having selected the required length, tighten the brass fittings and cut off the excess cable.
- 8) Re-connect the two sections (C-C1) and (E-E1), and tighten to adjust tension.
- 9) Tighten set screws on the wall bracket (F1) to affix the front and back cables in place.

**NOTE:** It is important to check the strength of the top fixing(s). NOVA DISPLAY® takes no responsibility for incorrect installation. This responsibility rests with the installer.

Cables are not supplied with fixing screws.

**\*\*\* DO NOT INSTALL INTO PLASTERBOARD (DRYWALL) CEILINGS OR WALLS IF YOUR APPLICATION INCLUDES GLASS SHELVING OR OTHER HEAVY ITEMS.**

