

# Installation Guidelines

**NOVADISPLAY**  
INNOVATIVE DISPLAY SOLUTIONS

## AnoQuick - Ball Chains

800.753.9688 [www.novadisplay.com](http://www.novadisplay.com)

**Note:** Use only with graphics mounted on 3/16" foamboard or other similar thickness. Can also use a folded edge thinner substrate.

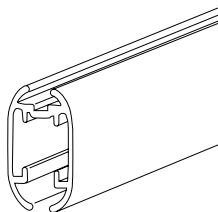

AnoQuick



Cable Clips



End Caps

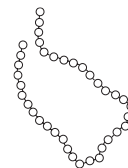

Ball Chains

### Instructions for Hanging

#### Step 1

Prepare edges of graphic. Place the graphic on tabletop with one edge at the table edge. Using the AnoQuick holder, run it across the graphic edge, crushing it slightly. **Fig. 1**

#### Step 2

Starting at one corner, push the holder onto the graphic. Work your way down the holder tapping it down firmly to seat the graphic fully. **Fig. 2**

#### Step 3

Insert single ball of ball chain into inner channel of Cable Clip. The cable should snap into place. **Fig. 3**

#### Step 4

Align one round end of cable clip with top channel of the aluminum rail and insert. Once in place, insert end of ball chain into channel. Then press down on the other round end of the cable clip and slide into rail by pushing on the clip. **Fig. 4**

**Note:** Be sure to slide the ball chain into place by pushing on the cable clip. Do not pull on, or push against, the ball chain as this will cause it to bind in the channel.

#### Step 5

Push end caps into place. **Fig. 5**

#### Step 6

Suspend poster. **Fig. 6**

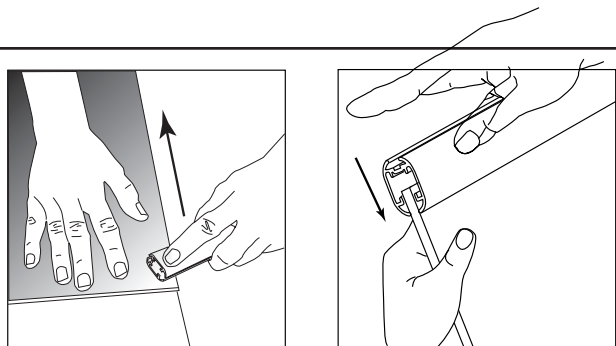

Figure 1

Figure 2

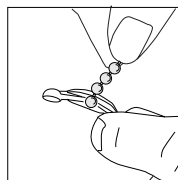

Figure 3

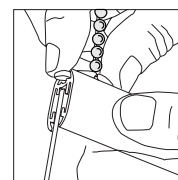
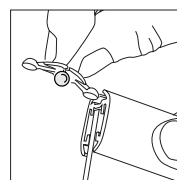

Figure 4

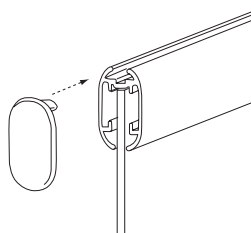

Figure 5

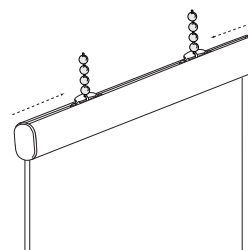

Figure 6

# Installation Guidelines

**NOVADISPLAY**  
INNOVATIVE DISPLAY SOLUTIONS

## AnoQuick - Loop & Saucer

800.753.9688 [www.novadisplay.com](http://www.novadisplay.com)

**Note:** Use only with graphics mounted on 3/16" foamboard or other similar thickness. Can also use a folded edge thinner substrate.

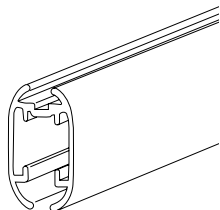

AnoQuick



Cable Clips



End Cap

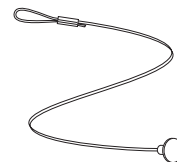

Loop & Saucer

### Instructions for Hanging

#### Step 1

Prepare edges of graphic. Place the graphic on tabletop with one edge at the table edge. Using the AnoQuick holder, run it across the graphic edge, crushing it slightly. **Fig. 1**

#### Step 2

Starting at one corner, push the holder onto the graphic. Work your way down the holder tapping it down firmly to seat the graphic fully. **Fig. 2**

#### Step 3

Insert single ball of ball chain into inner channel of Cable Clip. The cable should snap into place. **Fig. 3**

#### Step 4

Align one round end of cable clip with top channel of the aluminum rail and insert. Once in place, insert end of ball chain into channel. Then press down on the other round end of the cable clip and slide into rail by pushing on the clip. **Fig. 4**

#### Step 5

Push end caps into place. **Fig. 5**

#### Step 6

Suspend poster. **Fig. 6**

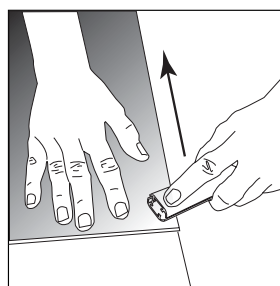

Figure 1

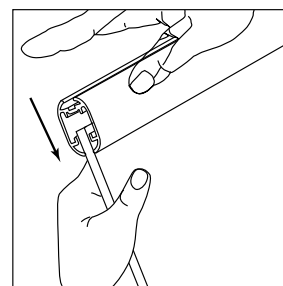

Figure 2

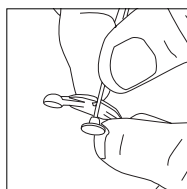

Figure 3

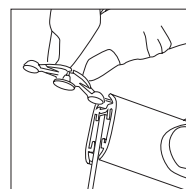

Figure 4

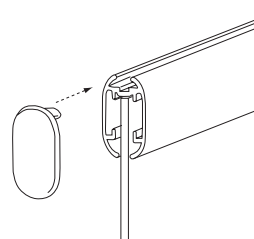
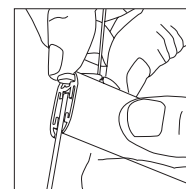

Figure 5

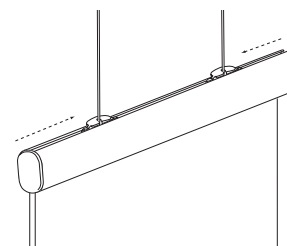

Figure 6

# Installation Guidelines

**NOVADISPLAY®**  
INNOVATIVE DISPLAY SOLUTIONS

## AnoQuick - Loop & Saucer

800.753.9688 [www.novadisplay.com](http://www.novadisplay.com)

**Note:** Use only with graphics mounted on 3/16" foamboard or other similar thickness. Can also use a folded edge thinner substrate.

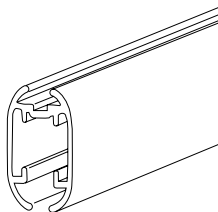

AnoQuick



Cable Clips



End Cap

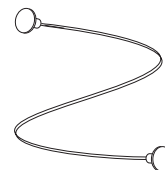

Cable & Saucer

### Instructions for Hanging

#### Step 1

Prepare edges of graphic. Place the graphic on tabletop with one edge at the table edge. Using the AnoQuick holder, run it across the graphic edge, crushing it slightly. **Fig. 1**

#### Step 2

Starting at one corner, push the holder onto the graphic. Work your way down the holder tapping it down firmly to seat the graphic fully. **Fig. 2**

#### Step 3

Insert single ball of ball chain into inner channel of Cable Clip. The cable should snap into place. **Fig. 3**

#### Step 4

Align one round end of cable clip with top channel of the aluminum rail and insert. Once in place, insert end of ball chain into channel. Then press down on the other round end of the cable clip and slide into rail by pushing on the clip. **Fig. 4**

#### Step 5

Push end caps into place. **Fig. 5**

#### Step 6

Suspend poster. **Fig. 6**

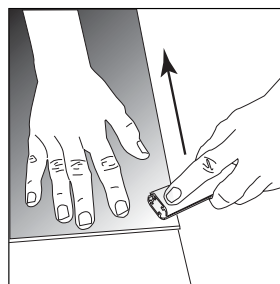

Figure 1

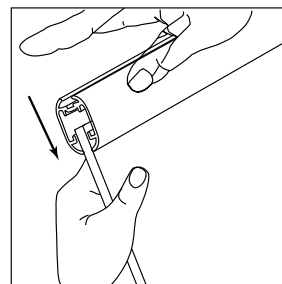

Figure 2

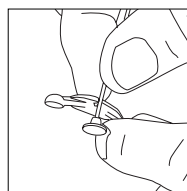

Figure 3

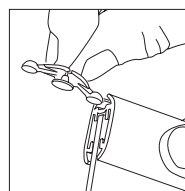

Figure 4

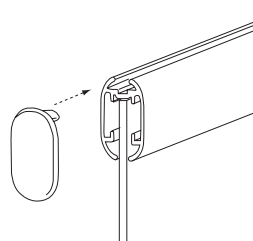
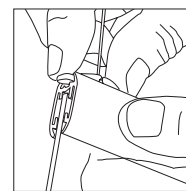

Figure 5

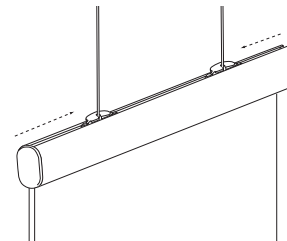

Figure 6

# Installation Guidelines

**NOVADISPLAY**  
INNOVATIVE DISPLAY SOLUTIONS

## AnoQuick - Slatwall Hangers

800.753.9688 [www.novadisplay.com](http://www.novadisplay.com)

**Note:** Use only with graphics mounted on 3/16" foamboard or other similar thickness. Can also use a folded edge thinner substrate.

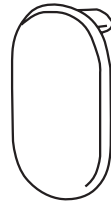

End Caps

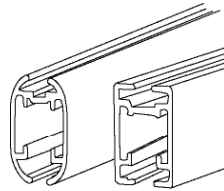

AnoQuick Round or Square

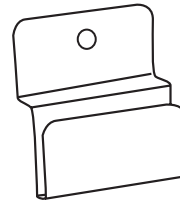

Slatwall Hangers

### Instructions for Hanging

#### Step 1

Prepare edges of graphic. Place the graphic on tabletop with one edge at the table edge. Using the AnoQuick holder, run it across the graphic edge, crushing it slightly. **Fig. 1**

#### Step 2

Starting at one corner, push the holder onto the graphic. Work your way down the holder tapping it down firmly to seat the graphic fully. **Fig. 2**

#### Step 3

Push end caps into place. **Fig. 3**

#### Step 4

Insert hangers into upper portion of slatwall. Hangers will rest on lower portion of slatwall. **Fig. 4**

**Note:** To ensure that the frame hangs level use two hangers placed an equal distance in from each side of the frame.

#### Step 5

Place the AnoQuick on the hangers using the bottom channel of the top rail.

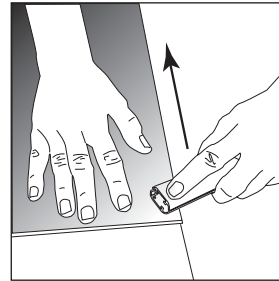

Figure 1

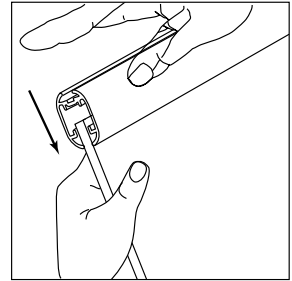

Figure 2

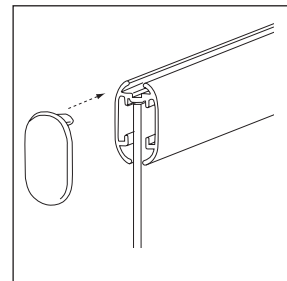

Figure 3

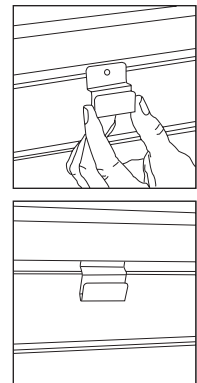

Figure 4

# Installation Guidelines

**NOVADISPLAY**  
INNOVATIVE DISPLAY SOLUTIONS

AnoQuick - MultiClips

800.753.9688 [www.novadisplay.com](http://www.novadisplay.com)

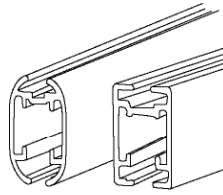

AnoQuick Round or Square

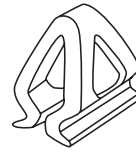

MultiClips



End Caps

## Instructions for Hanging

### Step 1

Insert dowel into sown pocket at top and bottom of graphic. **Fig. 1**

### Step 2

Insert dowel (with fabric) into the AnoQuick holder. **Fig. 2**

### Step 3

Squeeze sides of MultiClip together. **Fig.3**

### Step 4

Align the bottom rail of the MultiClip with the top channel of the aluminum holder. Slide MultiClip into rail. **Fig. 4**  
Repeat steps 3 & 4 for second MultiClip.

### Step 5

Push end caps into place. **Fig. 5 & 6**

### Step 6

Suspend poster. **Fig. 7**

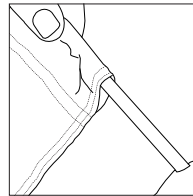

**Figure 1**

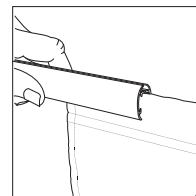

**Figure 2**

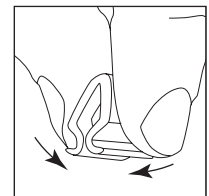

**Figure 3**

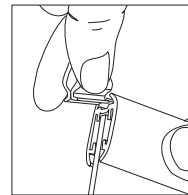

**Figure 4**

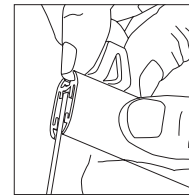

**Figure 5**

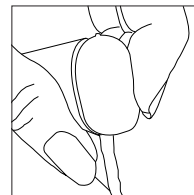
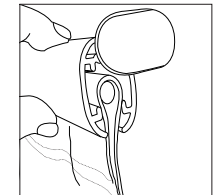

**Figure 6**

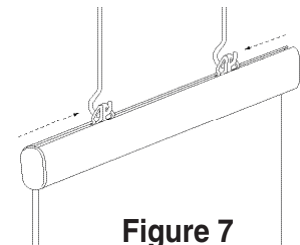

**Figure 7**

# Installation Guidelines

**NOVADISPLAY®**  
INNOVATIVE DISPLAY SOLUTIONS

AnoQuick - MultiClips

800.753.9688 [www.novadisplay.com](http://www.novadisplay.com)

**Note:** Use only with graphics mounted on 3/16" foamboard or other similar thickness. Can also use a folded edge thinner substrate.

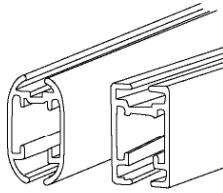

AnoQuick Round or Square

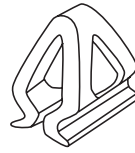

MultiClips



End Caps

## Instructions for Hanging

### Step 1

Prepare edges of graphic. Place the graphic on tabletop with one edge at the table edge. Using the AnoQuick holder, run it across the graphic edge, crushing it slightly. **Fig. 1**

### Step 2

Starting at one corner, push the holder onto the graphic. Work your way down the holder tapping it down firmly to seat the graphic fully. **Fig. 2**

### Step 3

Squeeze sides of MultiClip together. **Fig. 3**

### Step 4

Align the bottom rail of the MultiClip with the top channel of the aluminum holder. Slide MultiClip into rail. **Fig. 4**  
Repeat steps 3 & 4 for second MultiClip.

### Step 5

Push end caps into place. **Fig. 5 & 6**

### Step 6

Suspend poster. **Fig. 7**

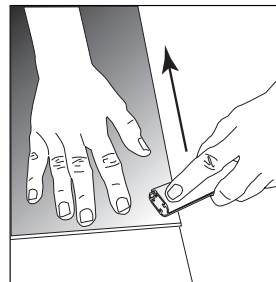

Figure 1

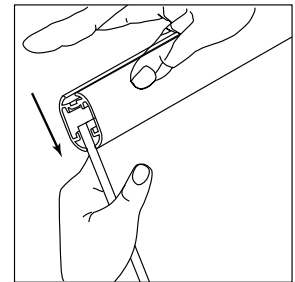

Figure 2

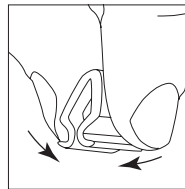

Figure 3

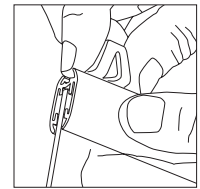
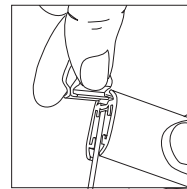

Figure 4

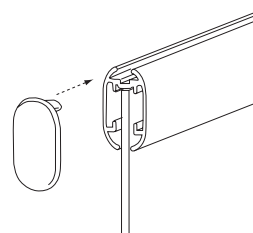

Figure 5

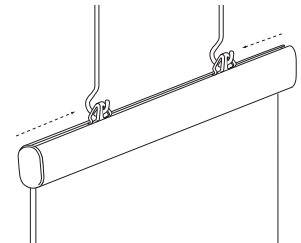
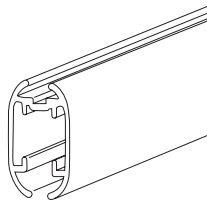
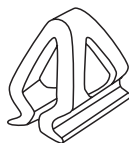

Figure 6

# Installation Guidelines



AnoQuick



MultiClips



End Caps

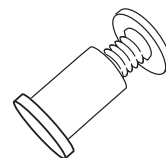

Pegs

## Instructions for Hanging

### Step 1

Have your printer punch three holes, evenly spaced, along the top and bottom edges of your graphic. **Fig. 1**

**Note:** Make sure holes are evenly spaced.

### Step 2

Push both parts of the peg together through each of the punched holes. **Fig. 2**

### Step 3

Slide AnoQuick onto substrate. The pegs should slide into the side rails. **Fig. 3**

**Note:** This is the easiest way to safely hang heavier substrates.

### Step 4

Squeeze sides of MultiClip together. **Fig. 4**  
Align the bottom rail of the MultiClip with the top channel of the holder.  
Slide MultiClip into rail. **Fig. 5**  
Repeat step 3 for second MultiClip.

### Step 5

Push end caps into place. **Fig. 6**

### Step 6

Suspend poster. **Fig. 7**

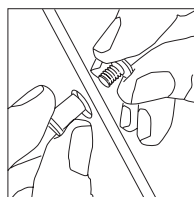

Figure 1

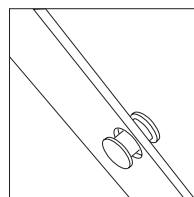

Figure 2

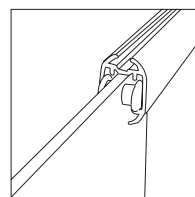

Figure 3

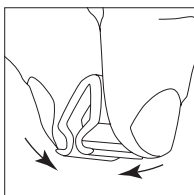

Figure 4

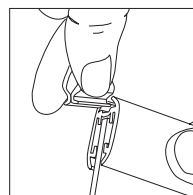

Figure 5

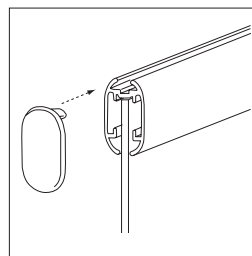
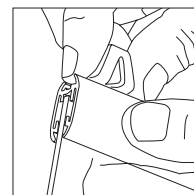

Figure 6

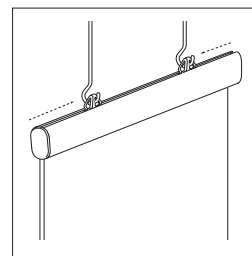
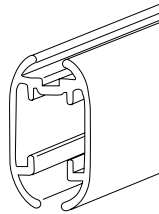
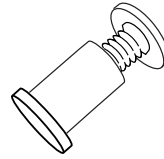

Figure 7

# Installation Guidelines



AnoQuick



Pegs

## Instructions for Hanging

### Step 1

When using AnoQuick to hang 1/8" Sintra or an equally heavy substrate, have your printer punch two 1/4" holes along the top and bottom edges of print — or only the top if no bottom holder is being used. **Fig. 1**

**Note:** Each hole must be centered 1/4" in from the edge of the substrate.

### Step 2

Push both parts of the peg together through each of the punched holes. **Fig. 2**

### Step 3

Slide AnoQuick onto substrate. The pegs should slide into the side rails. **Fig. 3**

**Note:** This is the easiest way to safely hang heavier substrates.

Figure 1

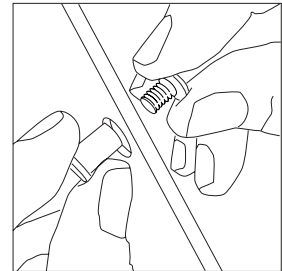

Figure 2

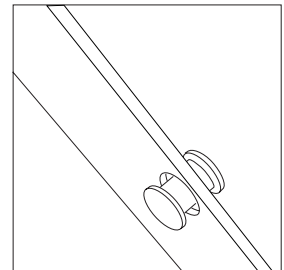
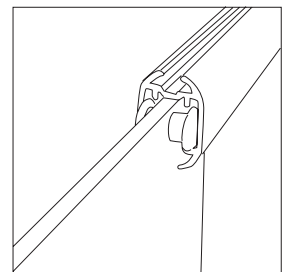

Figure 3



# Installation Guidelines

**NOVADISPLAY**  
INNOVATIVE DISPLAY SOLUTIONS

## AnoQuick - Wall Mount Hangers

800.753.9688 [www.novadisplay.com](http://www.novadisplay.com)

**Note:** Use only with graphics mounted on 3/16" foamboard or other similar thickness. Can also use a folded edge thinner substrate.

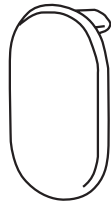

End Caps

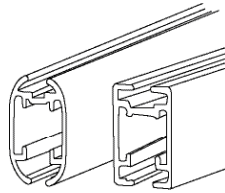

AnoQuick Round or Square

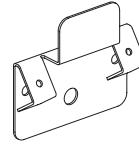

Wall Mount Hangers



Wood Screws or Molly Anchors

### Instructions for Hanging

#### Step 1

Prepare edges of graphic. Place the graphic on tabletop with one edge at the table edge. Using the AnoQuick holder, run it across the graphic edge, crushing it slightly. **Fig. 1**

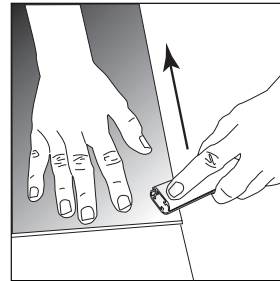

Figure 1

#### Step 2

Starting at one corner, push the holder onto the graphic. Work your way down the holder tapping it down firmly to seat the graphic fully. **Fig. 2**

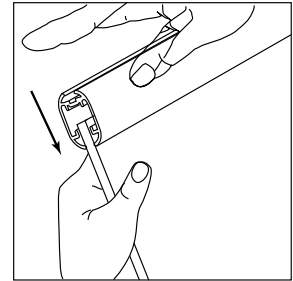

Figure 2

#### Step 3

Push end caps into place. **Fig. 3**

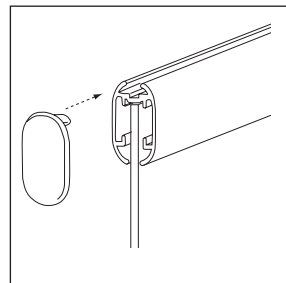

Figure 3

#### Step 4

Install wall mounting hangers using either nails or screw. Hammer nails into wall or use a Phillips head screwdriver for screws. **Fig. 4**

**Note:** The use of Molly Anchors are recommended for drywall installations (predrilling 3/16" holes is necessary).

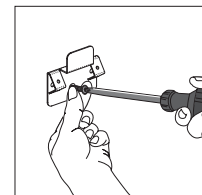
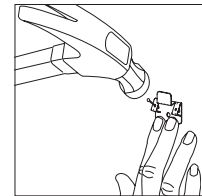

Figure 4

#### Step 5

Suspend poster.

# Installation Guidelines

**NOVADISPLAY**  
INNOVATIVE DISPLAY SOLUTIONS

## AnoQuick - Wall Mount Hangers

800.753.9688 [www.novadisplay.com](http://www.novadisplay.com)

**Note:** Use only with graphics mounted on 3/16" foamboard or other similar thickness. Can also use a folded edge thinner substrate.

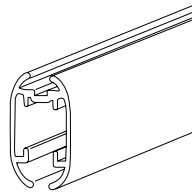

AnoQuick

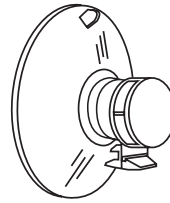

Window Mounts



End Caps

### Instructions for Hanging

#### Step 1

Prepare edges of graphic. Place the graphic on tabletop with one edge at the table edge. Using the AnoQuick holder, run it across the graphic edge, crushing it slightly. Fig. 1

#### Step 2

Starting at one corner, push the holder onto the graphic. Work your way down the holder tapping it down firmly to seat the graphic fully. Fig. 2

#### Step 3

Slide the Window Suction Cups into the top rail of the AnoMulti Holder. Fig. 3 & 4

#### Step 4

Push end caps into place. Fig. 5

#### Step 5

Suspend poster. Make sure glass and suction cups are clean and free of dust and dirt.

#### Important note:

For best performance when first applied and occasionally thereafter, press the middle of the cup (on the cap) to "burp" extra air out

