

AnoGotcha Plus Shells

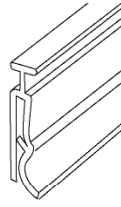

Gotcha Holder

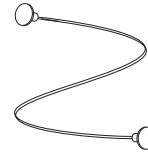

Cable and Saucer



Cable Clips

## Instructions for Hanging

### Step 1

Place poster on a flat surface.  
Snap the Gotcha holder open so hinge is turned up as far as possible. Insert graphic completely into holder until edge of graphic meets top of holder. **Fig. 1**  
To close, snap the Gotcha holder shut. **Fig. 2**

**Note:** It is easier to open and close the Gotcha holder by starting at one end and working your way down the holder. With large or curling graphics, it may be easier to insert graphic at one end and slide into holder from one end to another.

### Step 2

Insert Gotcha into AnoGotcha Plus Shell. **Fig. 3**

### Step 3

Place cable onto inner channel of Cable Clip.  
The cable should snap into place. **Fig. 4**  
Align one end of the Cable Clip with the top channel of the aluminum holder. Insert one round end, then press down on the other round end and slide Cable Clip into rail. **Fig. 5**

### Step 4

Push end caps into place. **Fig. 6**

### To Change Graphic:

Rotate one end cap on each AnoGotcha Plus 180° and slide out Gotcha. **Fig. 7**  
Repeat steps 1 and 2. Insert Gotcha back into the AnoGotcha Plus and rotate the end cap back into position.

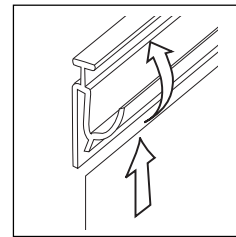

Figure 1

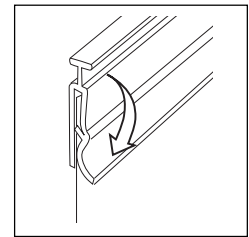

Figure 2

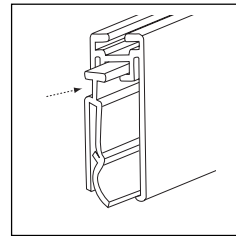

Figure 3

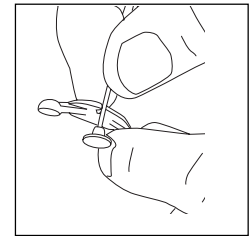

Figure 4



Figure 5

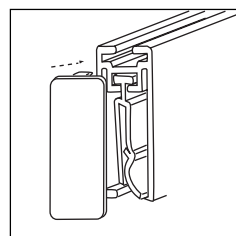

Figure 6

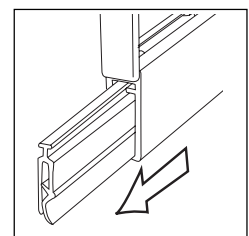
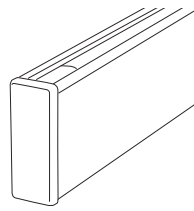
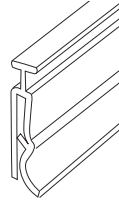

Figure 7



AnoGotcha Plus Shells



Gotcha Holder

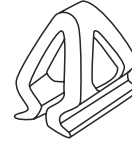

MultiClips

## Instructions for Hanging

### Step 1

Place poster on a flat surface.  
Snap the Gotcha holder open so hinge is turned up as far as possible. Insert graphic completely into holder until edge of graphic meets top of holder. **Fig. 1**  
To close, snap the Gotcha holder shut. **Fig. 2**

**Note:** It is easier to open and close the Gotcha holder by starting at one end and working your way down the holder. With large or curling graphics, it may be easier to insert graphic at one end and slide into holder from one end to another.

### Step 2

Insert Gotcha into AnoGotcha Plus Shell. **Fig. 3**

### Step 3

Squeeze sides of MultiClip together. **Fig. 4**  
Align the bottom rail of the MultiClip with the top channel of the aluminum holder.  
Slide MultiClip into rail. **Fig. 5**

### Step 4

Push end caps into place. **Fig. 6**

### To Change Graphic:

Rotate one end cap on each AnoGotcha Plus 180° and slide out Gotcha. **Fig. 7**  
Repeat steps 1 and 2. Insert Gotcha back into the AnoGotcha Plus and rotate the end cap back into position.

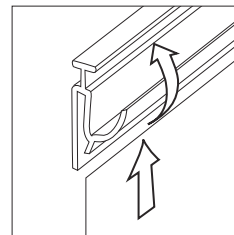

Figure 1

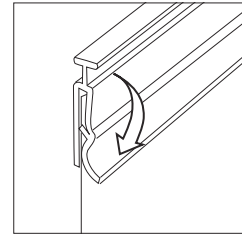

Figure 2

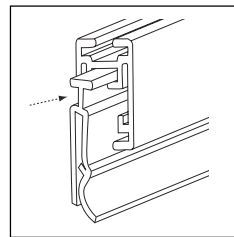

Figure 3

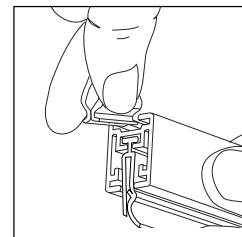

Figure 4

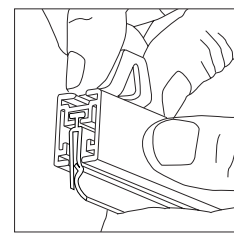

Figure 5

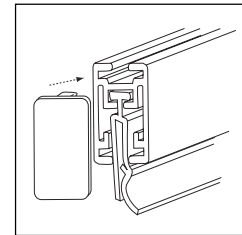

Figure 6

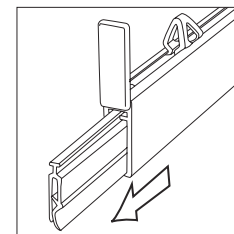
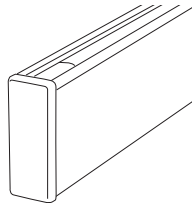
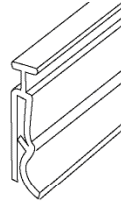

Figure 7



AnoGotcha Plus Shells



Gotcha Holder

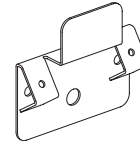

Frame Wall Mounting Hangers



Nails & Wood Screws or Molly Anchors

## Instructions for Hanging

### Step 1

Place poster on a flat surface.  
Snap the Gotcha holder open so hinge is turned up as far as possible. Insert graphic completely into holder until edge of graphic meets top of holder. **Fig. 1**  
To close, snap the Gotcha holder shut. **Fig. 2**

**Note:** It is easier to open and close the Gotcha holder by starting at one end and working your way down the holder. With large or curling graphics, it may be easier to insert graphic at one end and slide into holder from one end to another.

### Step 2

Insert Gotcha into AnoGotcha Plus Shell. **Fig. 3**

### Step 3

Push end caps into place. **Fig. 4**

### Step 4

Install wall mounting hangers using either nails or screw. Hammer nails into wall or use a Phillips head screwdriver for screws.

**Fig. 4**

**Note:** The use of Molly Anchors are recommended for drywall installations. (predrilling 3/16" holes is necessary).

### To Change Graphic:

Rotate one end cap on each AnoGotcha Plus 180° and slide out Gotcha. **Fig. 6**  
Repeat steps 1 and 2. Insert Gotcha back into the AnoGotcha Plus and rotate the end cap back into position.

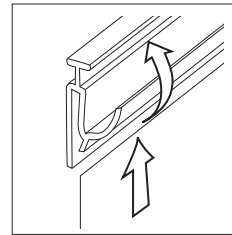

Figure 1

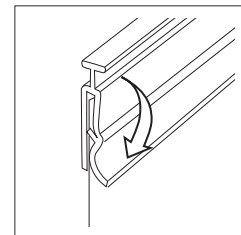

Figure 2

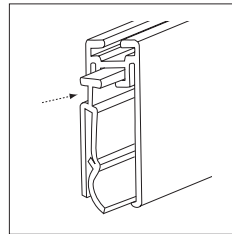

Figure 3

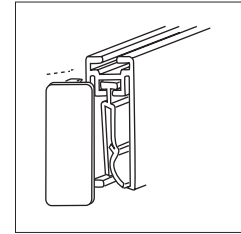

Figure 4

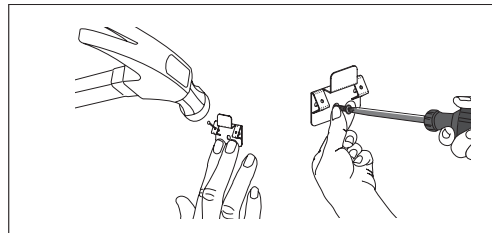

Figure 5

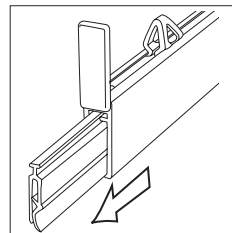
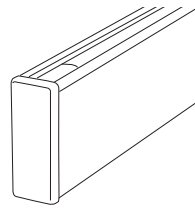
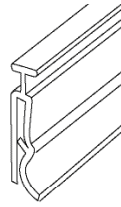

Figure 6



AnoGotcha Plus Shells



Gotcha Holder

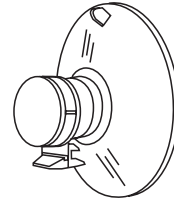

Window Mount

## Instructions for Hanging

### Step 1

Place poster on a flat surface.  
Snap the Gotcha holder open so hinge is turned up as far as possible. Insert graphic completely into holder until edge of graphic meets top of holder. **Fig. 1**  
To close, snap the Gotcha holder shut. **Fig. 2**

**Note:** It is easier to open and close the Gotcha holder by starting at one end and working your way down the holder. With large or curling graphics, it may be easier to insert graphic at one end and slide into holder from one end to another.

### Step 2

Insert Gotcha into AnoGotcha Plus Shell. **Fig. 3**

### Step 3

Slide Window Mounts into the top channel of the AnoGotcha Shell. **Fig. 4**

### Step 4

Push end caps into place. **Fig. 5**

### To Change Graphic:

Rotate one end cap on each AnoGotcha Plus 180° and slide out Gotcha. **Fig. 5**  
Repeat steps 1 and 2. Insert Gotcha back into the AnoGotcha Plus and rotate the end cap back into position.

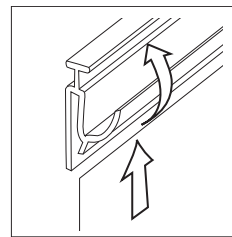

Figure 1

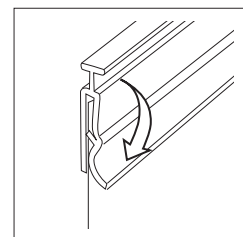

Figure 2

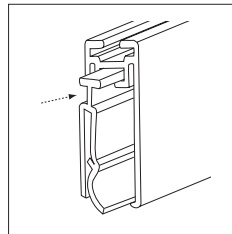

Figure 3

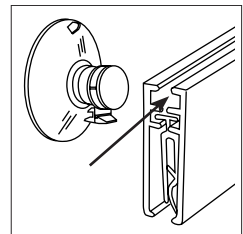

Figure 4

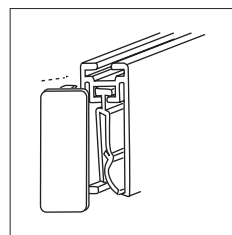

Figure 5