

# Installation Guidelines

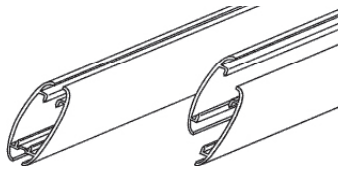

3  
AnoFrame  
Rails

2  
AnoFrame  
Split Rails



8  
Corner  
Brackets

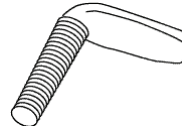

2  
Screw Tabs



2  
Transitional  
Collars

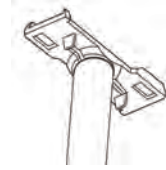

2 Vertical  
Posts with  
Ceiling Anchors

## Instructions For Assembly

### Step 1

Locate the two split rails and the solid rail that is the same length as the split rails. Insert corner brackets into side AnoFrame rails. Insert two corner brackets into each end of the solid side Ano rail. Insert one corner bracket into each end of each split side Ano rail. **Fig. 1 & Fig. 2**

**Note:** Tension tabs on corner brackets face towards outside of frame.

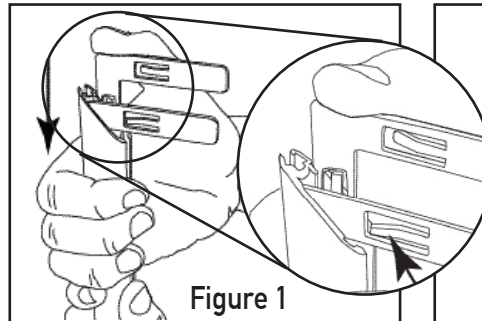

Figure 1

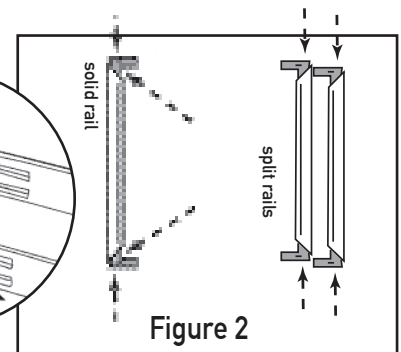

Figure 2

### Step 2

Slide both screw tabs into channel of top Ano rail. **Fig. 3**  
Place one near each end of frame.

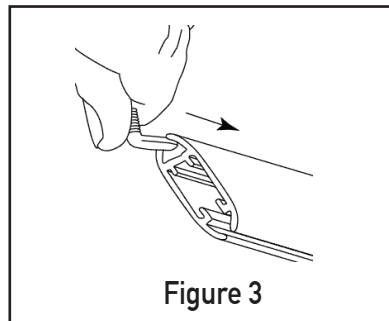

Figure 3

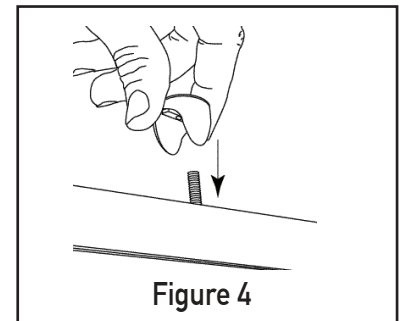

Figure 4

### Step 3

Place one transitional collar over each screw tab and push onto frame. **Fig. 4**

### Step 4

Finish assembling frame following the sequence in **Fig. 5**.

**Note:** Available in either round or square profile.

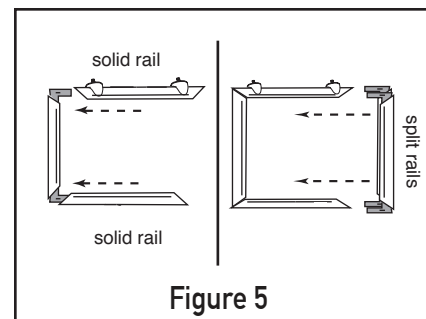

Figure 5

# Installation Guidelines

## Instructions For assembly

### Step 5

Screw vertical posts with ceiling anchors onto screw tabs on frame. Tighten. Fig. 6

### Step 6

Slide your graphic into the AnoFrame. Fig. 7

### Step 7

With your hand, twist ceiling anchors onto ceiling grid. Fig. 8  
You will hear the ceiling anchors snap into place.

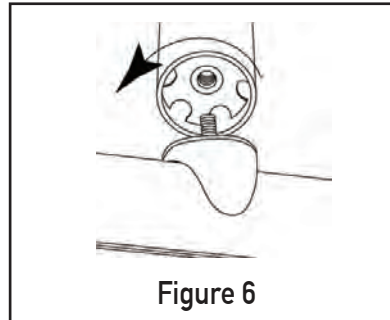

Figure 6

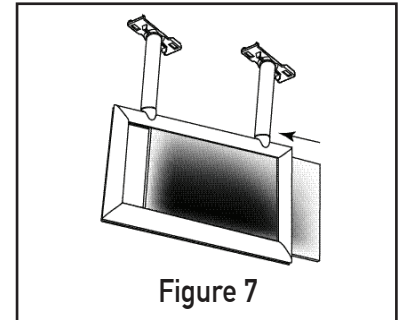

Figure 7

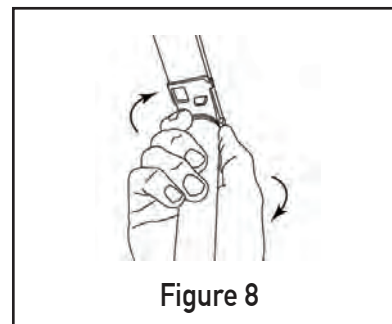
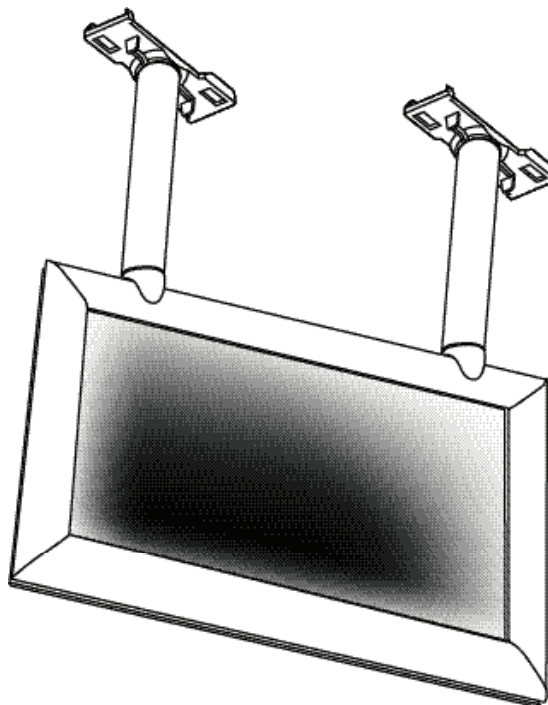

Figure 8



## Finished Look

**Note:** Available in either round or square profile.

# Installation Guidelines

**NOVADISPLAY**  
INNOVATIVE DISPLAY SOLUTIONS

AnoFrame VersaMount - Clamp Base - 1 of 2

800.753.9688 [www.novadisplay.com](http://www.novadisplay.com)

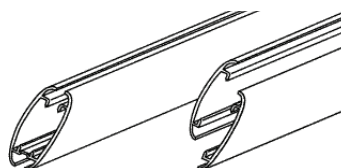

AnoFrame  
Rails



Corner  
Brackets

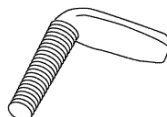

Screw Tab



Transitional  
Collar



Vertical  
Post



Clamp Base

## Instructions For Assembly

### Step 1

Locate the two split rails and the solid rail that is the same length as the split rails. Insert corner brackets into side AnoFrame rails. Insert two corner brackets into each end of the solid side Ano rail. Insert one corner bracket into each end of each split side Ano rail. **Fig. 1 & Fig. 2**

**Note:** Tension tabs on corner brackets face towards outside of frame.

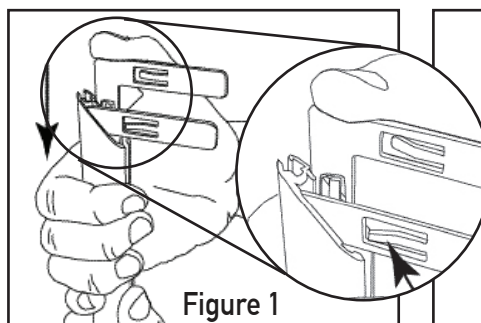

Figure 1

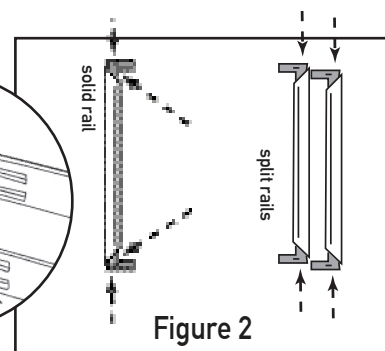

Figure 2

### Step 2

Slide screw tab into channel of bottom Ano rail. **Fig. 3.**

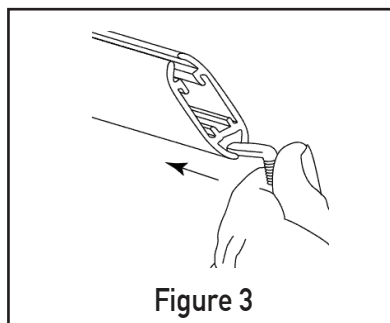

Figure 3

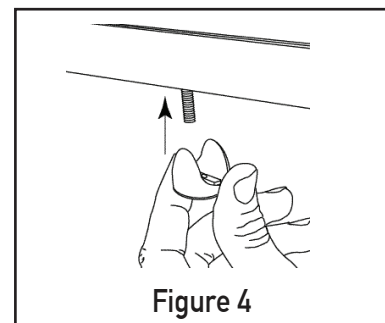

Figure 4

### Step 3

Place transitional collar over screw tab and push onto frame. **Fig. 4.**

### Step 4

Finish assembling frame following the sequence in **Fig. 5.**

**Note:** Placement of split rails will depend on type of frame. Split rails will be on the top for top-loading frames and on the side for side-loading frames.

**Note:** Available in either round or square profile.

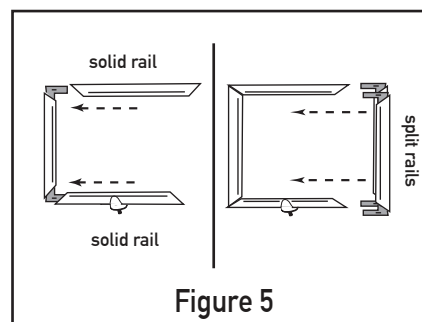

Figure 5

# Installation Guidelines

## Instructions for assembly

### Step 5

Screw vertical post onto screw tab on frame and tighten. **Fig. 6**

**Note:** Use the end of the post with the smaller opening.

### Step 6

Screw the clamp base onto the end of the vertical post and tighten. **Fig. 7**

### Step 7

Slide your graphic into the AnoFrame. **Fig. 8**

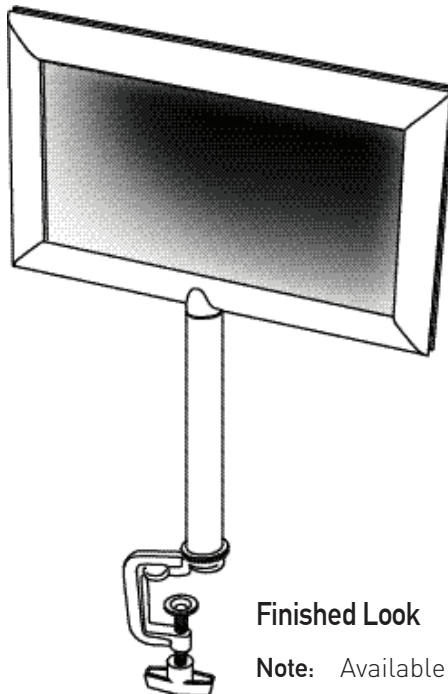
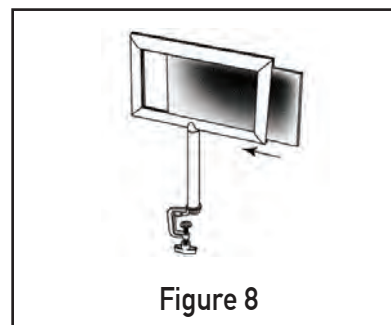
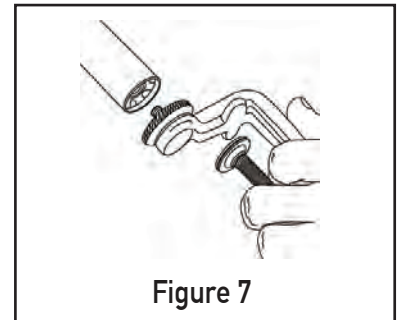
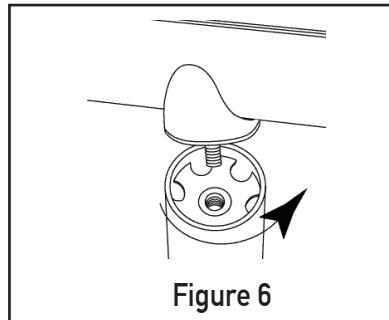

### Finished Look

**Note:** Available in either round or square profile.

# Installation Guidelines

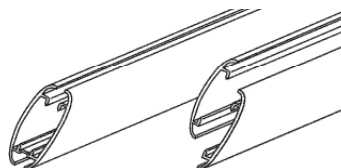

AnoFrame  
Rails



Corner  
Brackets

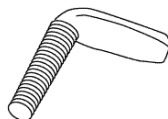

Screw Tab



Transitional  
Collar



Vertical  
Post

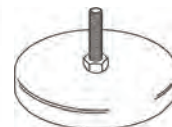

Magnet Base

## Instructions For Assembly

### Step 1

Locate the two split rails and the solid rail that is the same length as the split rails. Insert corner brackets into side AnoFrame rails. Insert two corner brackets into each end of the solid side Ano rail. Insert one corner bracket into each end of each split side Ano rail. **Fig. 1 & Fig. 2**

**Note:** Tension tabs on corner brackets face towards outside of frame.

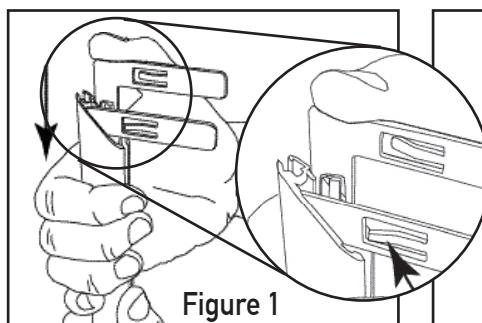

Figure 1

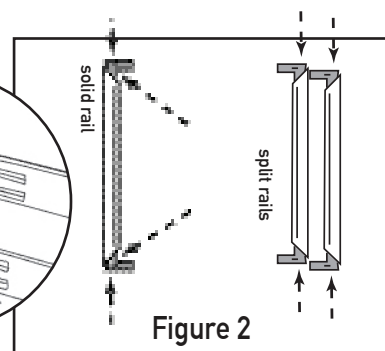

Figure 2

### Step 2

Slide screw tab into channel of bottom Ano rail. **Fig. 3.**

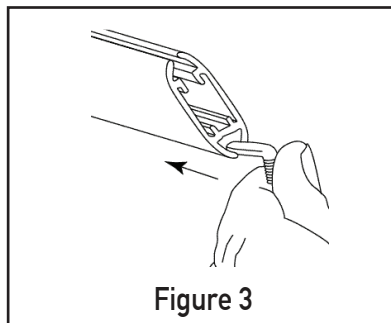

Figure 3

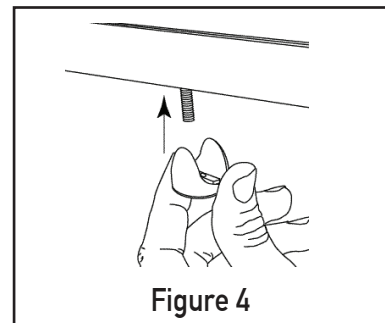

Figure 4

### Step 3

Place transitional collar over screw tab and push onto frame. **Fig. 4.**

### Step 4

Finish assembling frame following the sequence in **Fig. 5.**

**Note:** Placement of split rails will depend on type of frame. Split rails will be on the top for top-loading frames and on the side for side-loading frames.

**Note:** Available in either round or square profile.

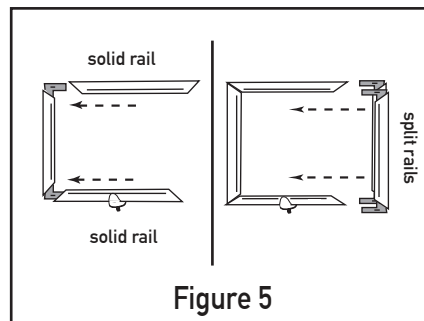

Figure 5

# Installation Guidelines

## Instructions for assembly

### Step 5

Screw vertical post onto screw tab on frame and tighten. **Fig. 6**

**Note:** Use the end of the post with the smaller opening.

### Step 6

Screw the vertical post onto the magnet base and tighten. **Fig. 7**

### Step 7

Slide your graphic into the AnoFrame. **Fig. 8**

**Note:** Depending on the size of your frame, you may require 2 poles & bases.

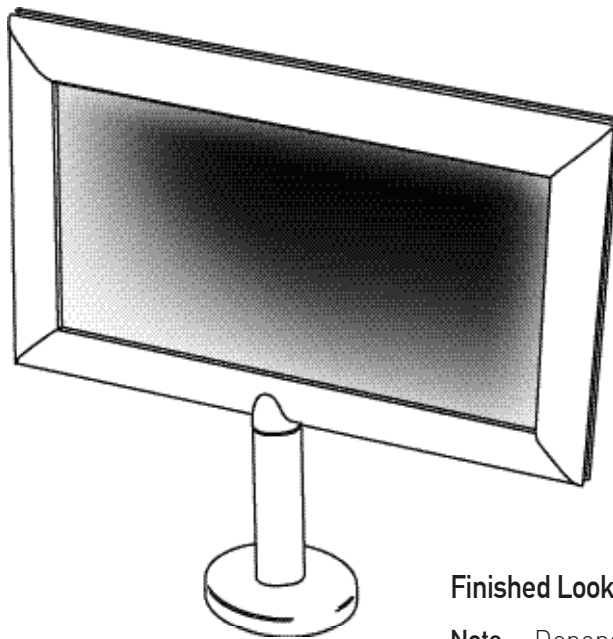
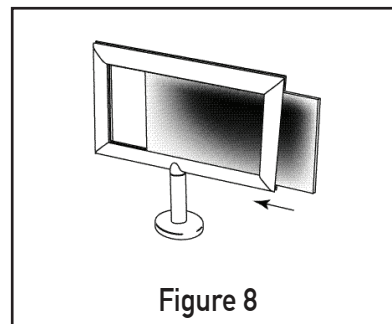
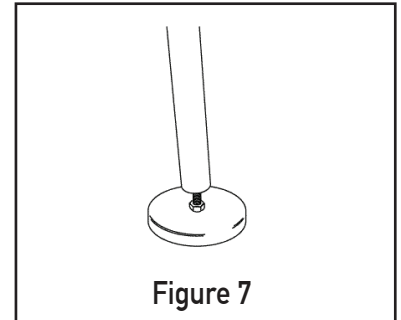
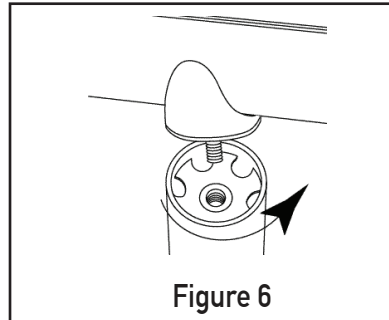

## Finished Look

**Note:** Depending on the size of your frame, you may require 2 poles & bases.

# Installation Guidelines

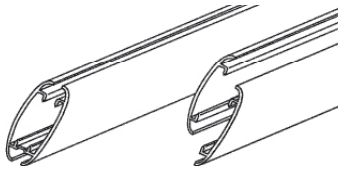

AnoFrame  
Rails



Corner  
Brackets

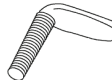

Screw Tab



Transitional  
Collar



Vertical  
Post

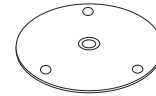

Screw Base



Screws

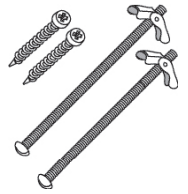

Wood Screws  
or Togglebolts

## Instructions For Assembly

### Step 1

Locate the two split rails and the solid rail that is the same length as the split rails. Insert corner brackets into side AnoFrame rails. Insert two corner brackets into each end of the solid side Ano rail. Insert one corner bracket into each end of each split side Ano rail. **Fig. 1 & Fig. 2**

**Note:** Tension tabs on corner brackets face towards outside of frame.

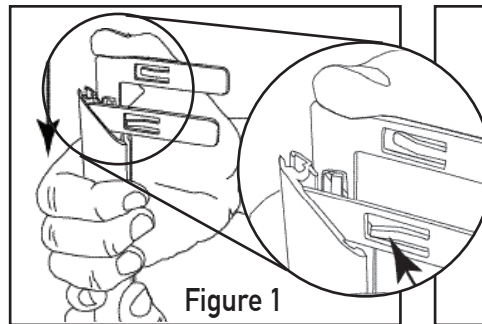

Figure 1

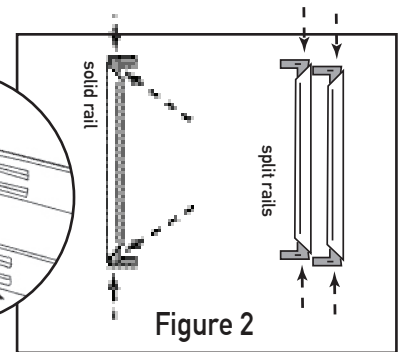

Figure 2

### Step 2

Slide screw tab into channel of bottom Ano rail. **Fig. 3.**

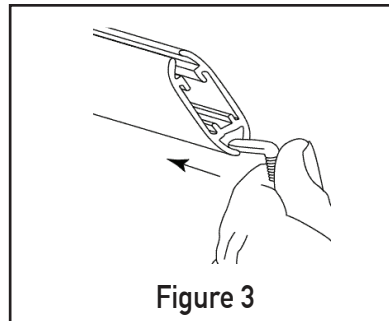

Figure 3

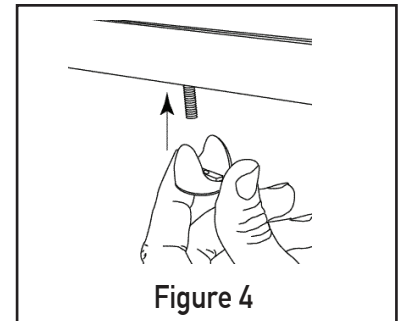

Figure 4

### Step 3

Place transitional collar over screw tab and push onto frame. **Fig. 4.**

### Step 4

Finish assembling frame following the sequence in Fig. 5.

**Note:** Placement of split rails will depend on type of frame. Split rails will be on the top for top-loading frames and on the side for side-loading frames.

**Note:** Available in either round or square profile.

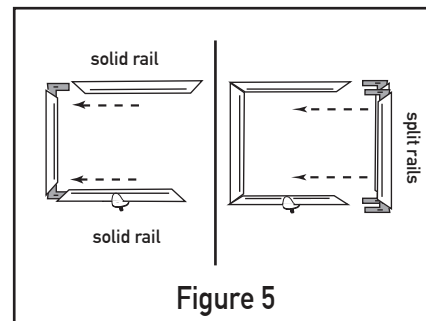

Figure 5



# Installation Guidelines

**NOVADISPLAY**  
INNOVATIVE DISPLAY SOLUTIONS

AnoFrame VersaMount - Screw Base - 2 of 2

800.753.9688 [www.novadisplay.com](http://www.novadisplay.com)

## Instructions For Assembly

### Step 5

Screw vertical post onto screw tab on frame and tighten. **Fig. 6**

**Note:** Use the end of the post with the smaller opening.

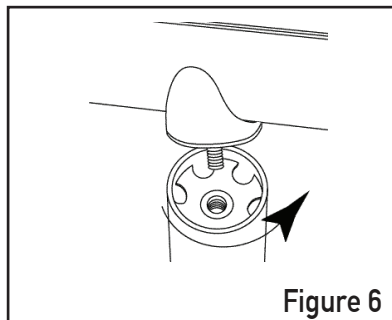

**Figure 6**

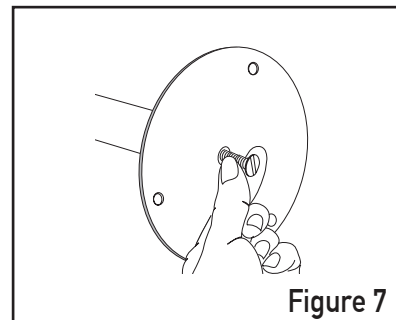
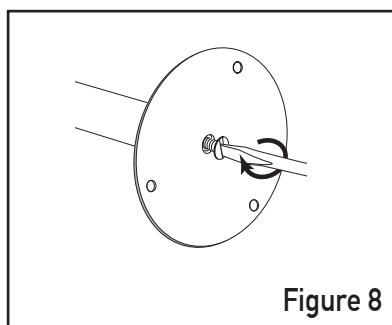

**Figure 7**

### Step 6

Insert one screw through the middle opening on each screw base and into the posts. **Fig. 7**

Tighten with screwdriver. **Fig. 8**



**Figure 8**

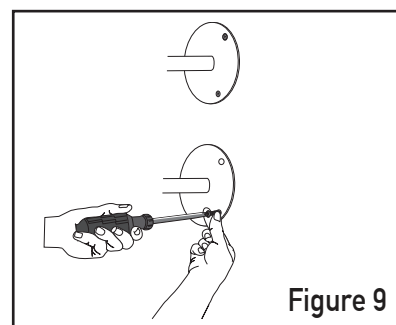

**Figure 9**

### Step 7

Install screw bases using wood screws and screwdriver. **Fig. 9**

**Note:** Togglebolts are recommended for drywall installations (predrilling 3/8" holes is necessary)

### Step 8

Slide your graphic into the AnoFrame. **Fig. 10**

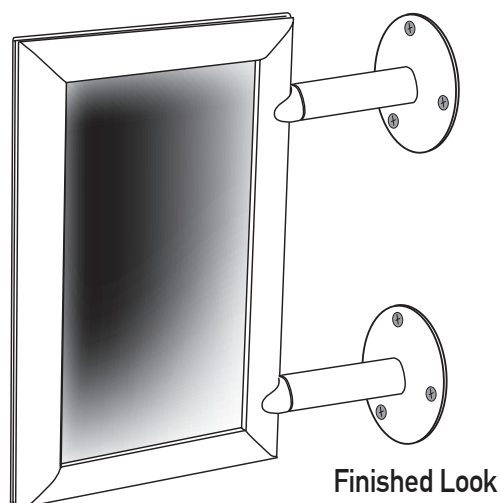

**Finished Look**

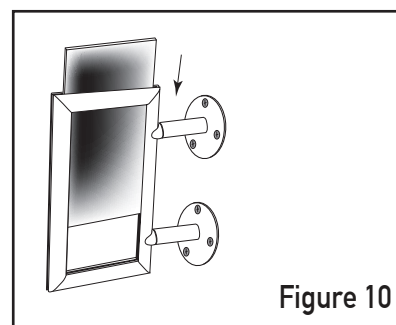

**Figure 10**



# Installation Guidelines

**NOVADISPLAY**  
INNOVATIVE DISPLAY SOLUTIONS

AnoFrame VersaMount - Weighted Base - 1 of 2

800.753.9688

www.novadisplay.com

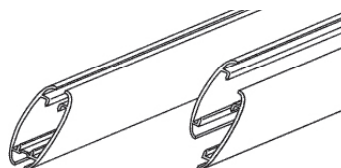

AnoFrame  
Rails



Corner  
Brackets

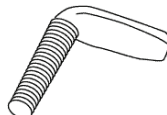

Screw Tab



Transitional  
Collar



Vertical  
Post

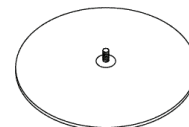

Weighted Base

## Instructions For Assembly

### Step 1

Locate the two split rails and the solid rail that is the same length as the split rails. Insert corner brackets into side AnoFrame rails. Insert two corner brackets into each end of the solid side Ano rail. Insert one corner bracket into each end of each split side Ano rail. **Fig. 1 & Fig. 2**

**Note:** Tension tabs on corner brackets face towards outside of frame.

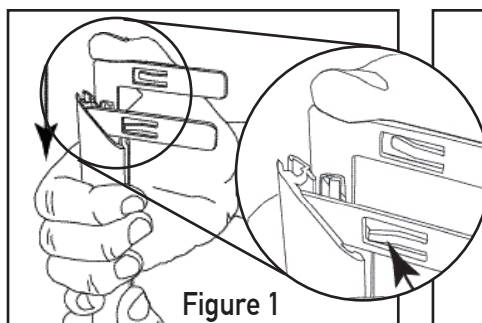

Figure 1

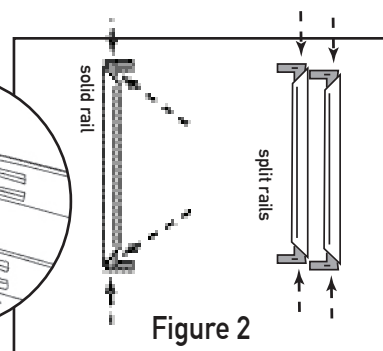

Figure 2

### Step 2

Slide screw tab into channel of bottom Ano rail. **Fig. 3.**

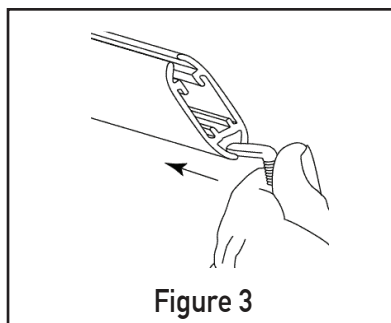

Figure 3

### Step 3

Place transitional collar over screw tab and push onto frame. **Fig. 4.**

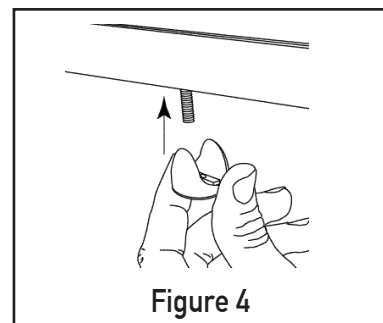

Figure 4

### Step 4

Finish assembling frame following the sequence in **Fig. 5.**

**Note:** Placement of split rails will depend on type of frame. Split rails will be on the top for top-loading frames and on the side for side-loading frames.

**Note:** Available in either round or square profile.

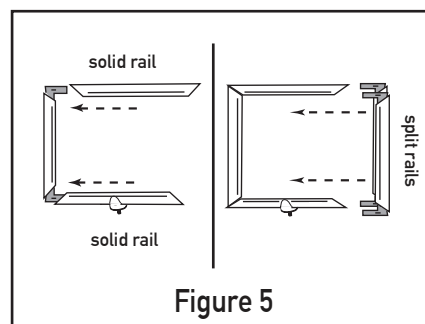

Figure 5

# Installation Guidelines

## Instructions for assembly

### Step 5

Screw vertical post onto screw tab on frame and tighten. Fig. 6

**Note:** Use the end of the post with the smaller opening.

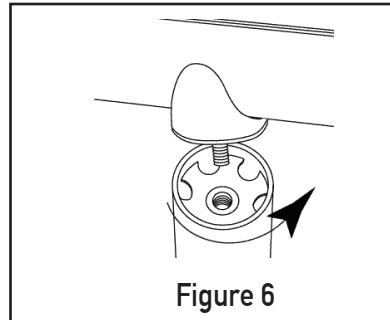

Figure 6

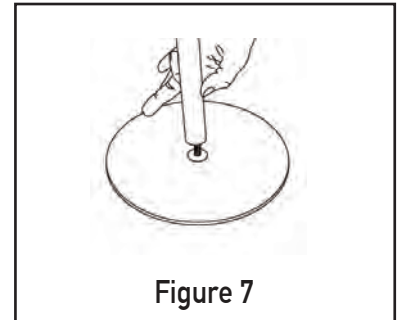

Figure 7

### Step 6

Screw the vertical post onto the weighted base and tighten. Fig. 7

### Step 7

Slide your graphic into the AnoFrame. Fig. 8

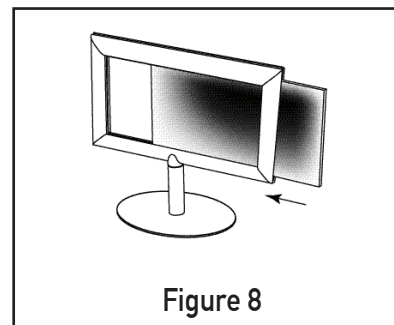
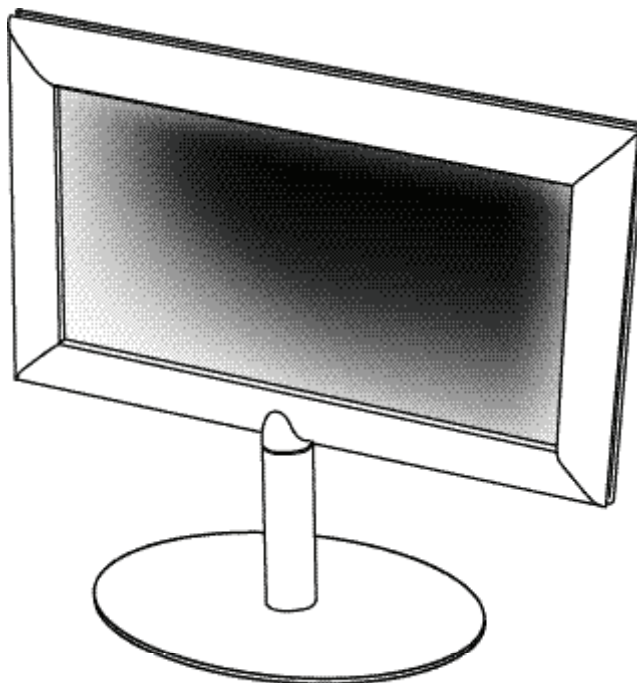

Figure 8



Finished Look