

Installation Guidelines

NOVADISPLAY®
INNOVATIVE DISPLAY SOLUTIONS

1.5mm Cable Display Systems

800.753.9688 • www.novadisplay.com

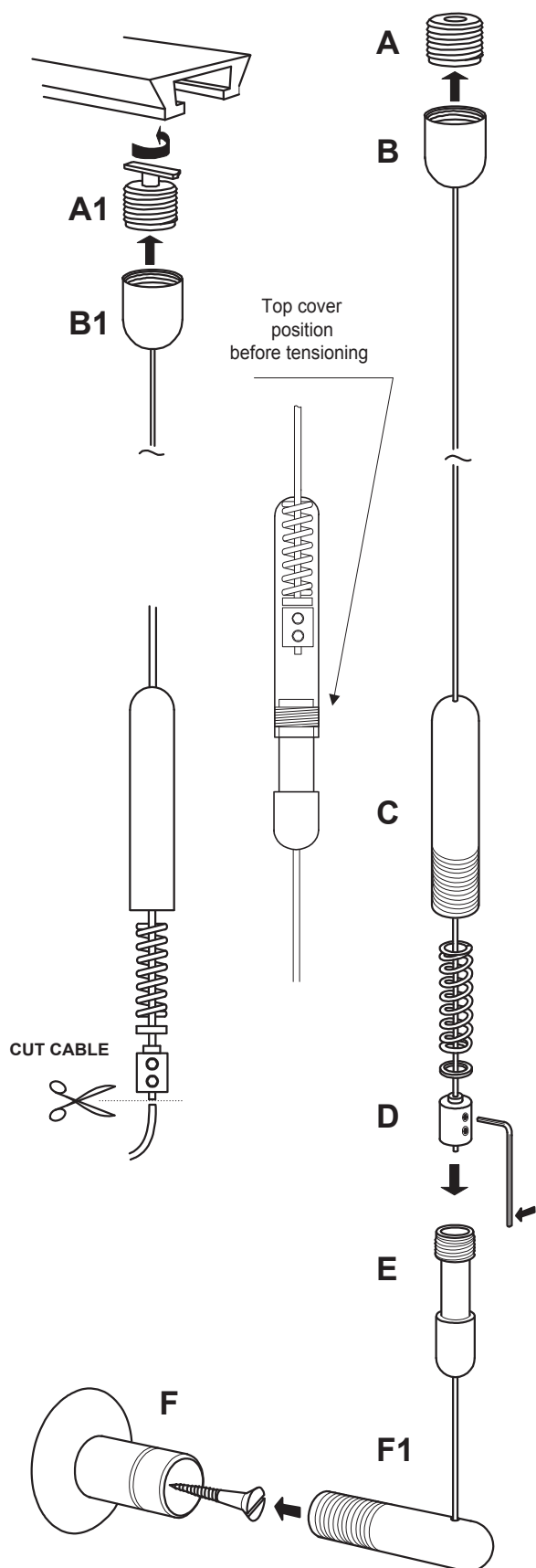

INSTALLATION TIPS

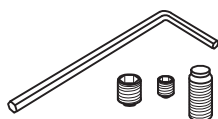
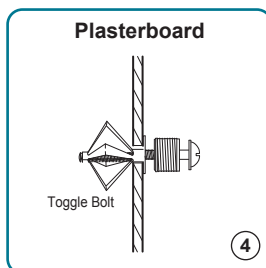
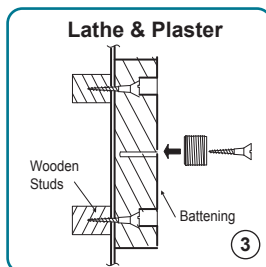
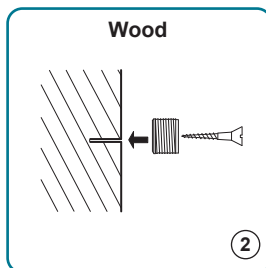
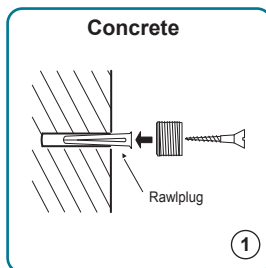

Ceiling to Wall (CCW) - Cable Installation

IMPORTANT: It is essential to check that the top ceiling fixings are strong enough to take the weight of the items being displayed, while allowing for the tension in the cables.

- 1) Affix fitting (A) to ceiling:
 - for wooden ceilings use a wood screw.
 - for cavity ceilings use a spring toggle bolt.
 - for solid ceilings use a rawl plug and screw.
- 2) Screw fitting (B) to fitting (A).
- 3) Using a plumb line, descend from (A) to the required position for base fitting (F) and affix.
- 4) Separate the two sections of part (C) and (E) and loosen the grub screws in the small brass piece (D), using the allen key provided, and slide fittings up the cable to the desired length. (Do not remove from cable).
- 5) Having selected the required length, tighten the brass fitting and cut off the excess cable.
- 6) Re-connect the two sections (C) and (E), and tighten to adjust tension.

Note: It is important to check the strength of the top fixing(s). NOVADISPLAY® takes no responsibility for incorrect installation. This responsibility rests with the installer.

Cables are not supplied with fixing screws.

