

Cable Suspended LED Light Pocket



If the LED Light Pockets do not illuminate after completing Step 6, unplug the Transformer and switch the Power Lines connected to the CS08 Power Connectors. After securing the Power Lines plug the Transformer in to the Outlet and the LED Light Pockets will illuminate.

Installation Guidelines

NOVADISPLAY®
INNOVATIVE DISPLAY SOLUTIONS

Cable Suspended LED Light Pocket

800.753.9688 • www.novadisplay.com

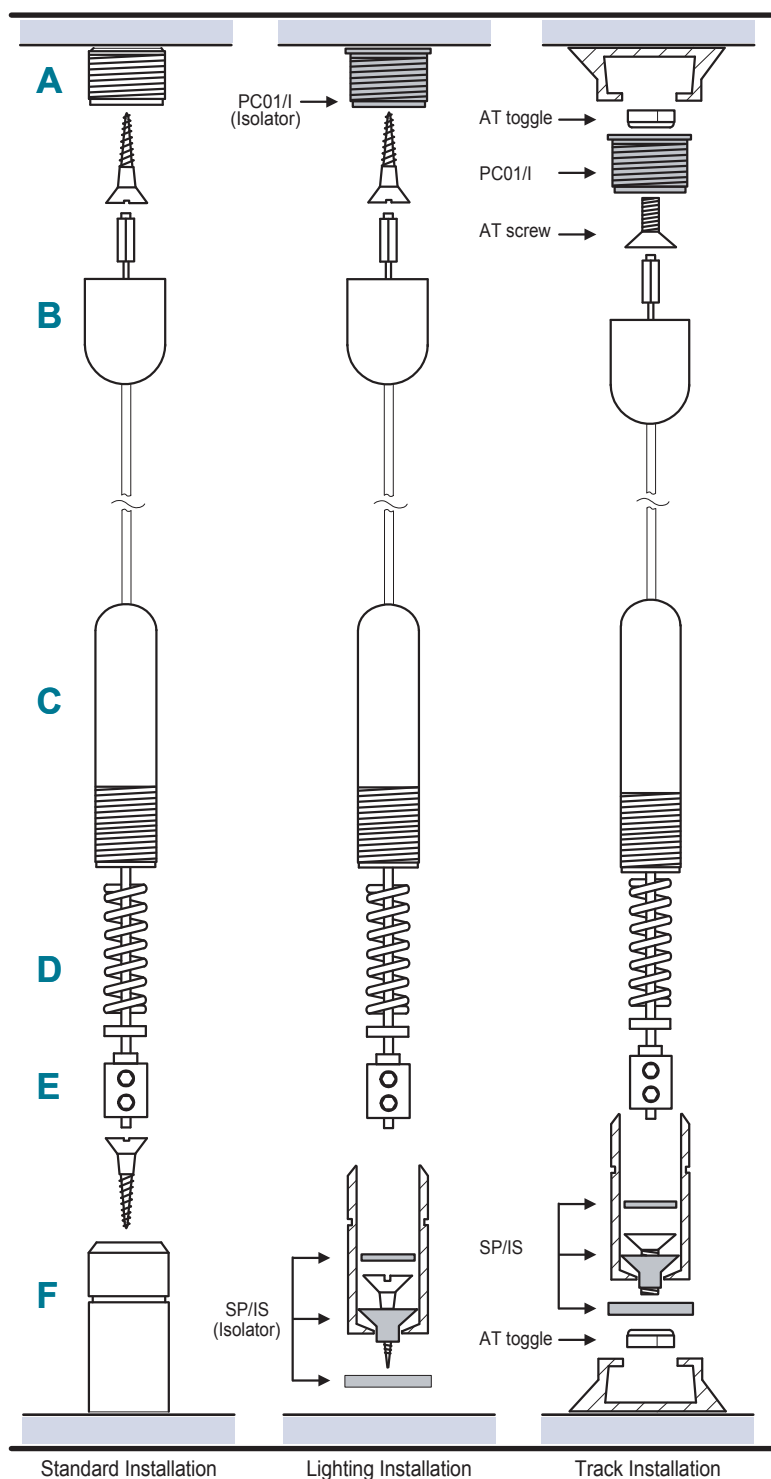
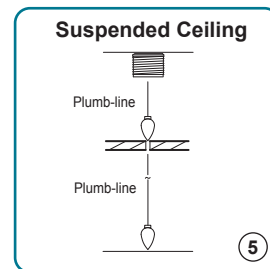
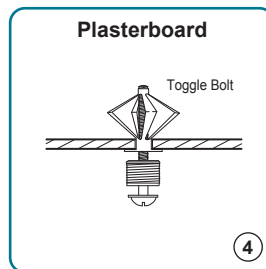
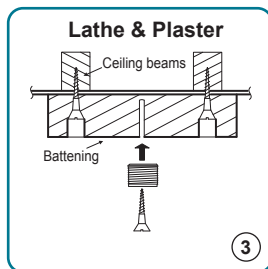
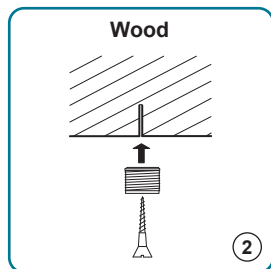
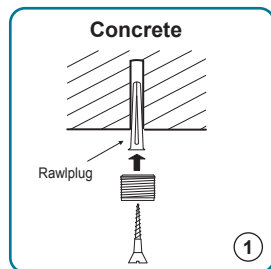

Top to Bottom (CA4) - Cable Installation

IMPORTANT: It is essential to check that the top ceiling fixings are strong enough to take the weight of the items being displayed, while allowing for the tension in the cables.

Isolators must be used where power is required through the cables (lighting etc), and fixings are into metal, or conductive materials.

When fitting isolated cables remember to replace the top brass fitting with the plastic **PC01/I** isolator, and add bottom isolator **SP/IS** to bottom fitting.

- 1) Fix fitting (A) to ceiling:
- 2) Screw fitting (B) to fitting (A).
- 3) Using a plumb-line, descend from (A), and affix (F) to the floor using appropriate type of fixing. For isolated cable remember to include the **SP/IS**.
- 4) Loosen the grub screws in fitting (E), using the hex-key provided, and slide fittings (C), (D), and (E) up the cable.
- 5) Pull down and cut off excess cable in-line with the decorative line around fitting (F) (see below).
- 6) Tighten (E) on the end of the cable.
- 7) Adjust the tension of the cable by screwing (C) into (F).

NOTE: It is important to check the strength of the top fixing. NOVA DISPLAY® takes no responsibility for incorrect installation. This responsibility rests with the installer.

Cables are not supplied with fixing screws.

