

Stack-On Display Stand Installation Guidelines

KFST-001, 002, 003, 006

6

Position the top Horizontal Extrusion at the appropriate height and lock the attached CBX connectors into place with a hex-key

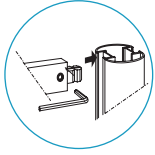

7

Attach End Caps to the tops of the Vertical Extrusions

5

Slide the top Graphic Panel into the channel of the Vertical Extrusions & center Horizontal Extrusion

4

Position the center Horizontal Extrusion at the appropriate height and lock the attached CBX connectors into place with a hex-key

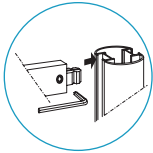

3

Slide the bottom Graphic Panel or Leaflet Dispensers into the channel of the Vertical Extrusions & bottom Horizontal Extrusion

2

Position the bottom Horizontal Extrusion at the appropriate height and lock the attached CBX connectors into place with a hex-key

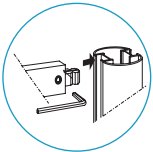

1

Attach the Vertical Extrusions to the floor bases using Insert Blocks, with set screws and a hex-key

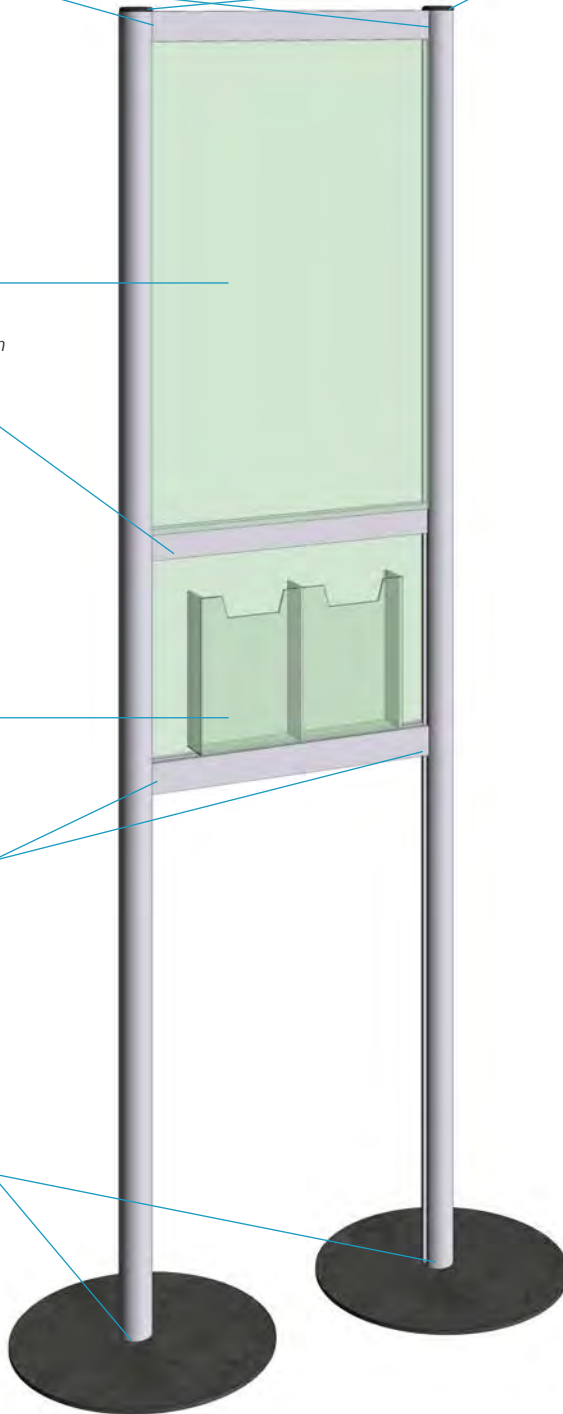
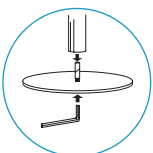

Read instruction sheet carefully before starting assembly □ Separate all parts and check quantities □ Account for all parts before discarding any packaging materials

INDEX OF APPLICABLE MODELS:

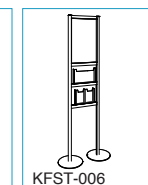
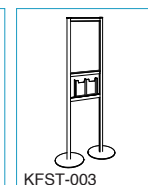
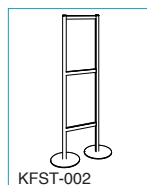
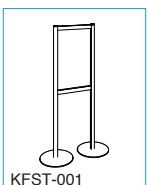

Stack-On Display Stand Installation Guidelines

KFST-004, 005, 007, 008, 009, 010

6
Position the center-top Horizontal Extrusion at the appropriate height and lock the attached CBX connectors into place with a hex-key

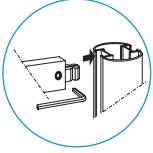

5
Slide the center-top Graphic Panel into the channel of the Vertical Extrusions & center Horizontal Extrusion

4
Position the center Horizontal Extrusion at the appropriate height and lock the attached CBX connectors into place with a hex-key

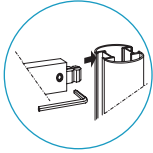

3
Slide the bottom Graphic Panel or Leaflet Dispensers into the channel of the Vertical Extrusions & bottom Horizontal Extrusion

2
Position the bottom Horizontal Extrusion at the appropriate height and lock the attached CBX connectors into place with a hex-key

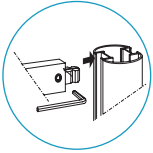

1
Attach the Vertical Extrusions to the floor bases using Insert Blocks, with set screws and a hex-key

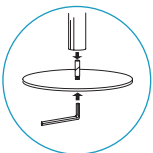

9
Attach End Caps to the tops of the Vertical Extrusions

8
Position the top Horizontal Extrusion at the appropriate height and lock the attached CBX connectors into place with a hex-key

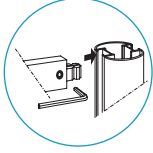

7
Slide the top Logo Panel into the channel of the Vertical Extrusions & center Horizontal Extrusion

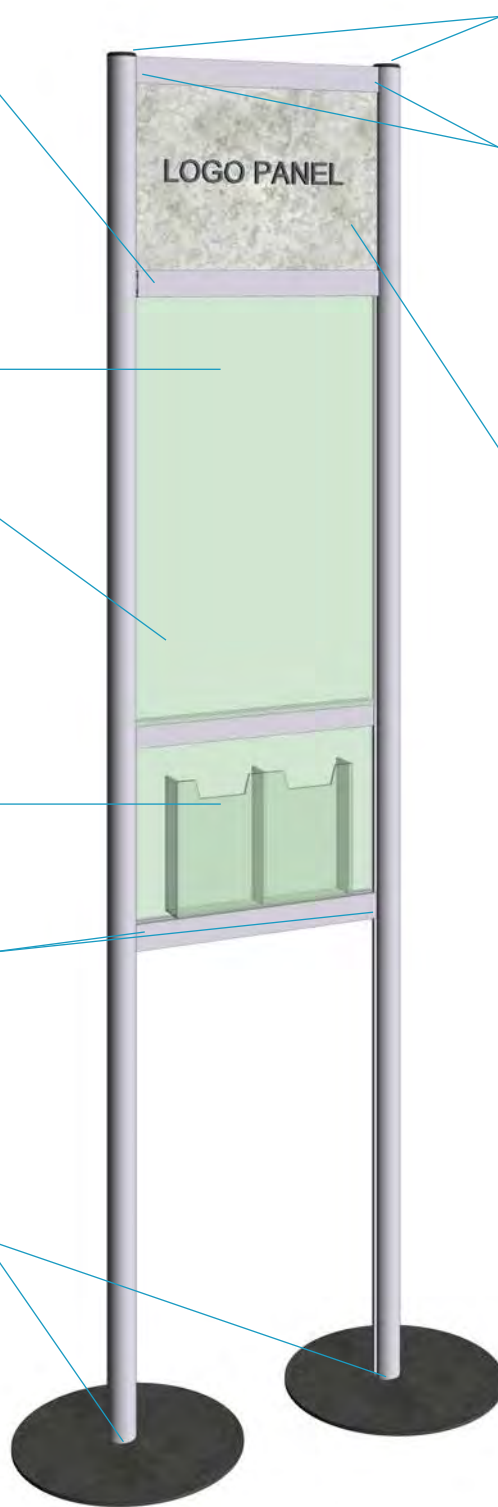

Read instruction sheet carefully before starting assembly □ Separate all parts and check quantities □ Account for all parts before discarding any packaging materials

INDEX OF APPLICABLE MODELS:

